



sound bar  
**NEB Juke Bar**  
**NEB 4050**



# User Manual

[www.zebronics.com](http://www.zebronics.com)

## Important Safety Instruction

Thank you for purchasing the **ZEB-JUKE BAR 4050** Soundbar. Please read this user manual carefully and keep for future reference.

### Warning

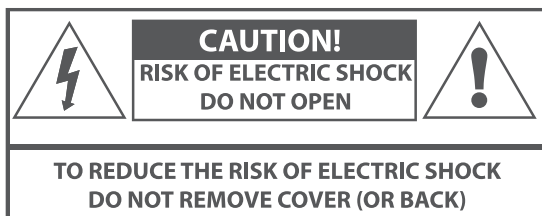

### Caution:

- To reduce the risk of electric shock, do not dismantle the product and do not expose the apparatus to rain or moisture. No user-serviceable parts inside.
- Refer servicing to qualified personnel only.



The lightning flash within an equilateral triangle is intended to alert you to the presence of uninsulated dangerous voltage within the product's enclosure that may be of sufficient magnitude to constitute an electric shock to a person or persons.



Important! This symbol alerts you to read and observe important warnings and instructions on the unit or in this manual.

### **Notice:**

This appliance is not intended for use by persons (including children) with reduced physical sensory or mental capabilities, or lack of experience and knowledge, unless they have been given supervision or instruction concerning use of the appliance by a person responsible for their safety.

Children should be supervised to ensure that they do not play with the appliance.

1. To prevent possible hearing damage, do not listen at high volume levels for long time periods or a sudden high volume level.



2. Never use the device unsupervised! Switch off the device whenever you are not using it, even if not using it only for a short while.
3. The appliance is not intended to be operated by means of an external timer or separate remote control system.
4. If the supply cord is damaged, it must be replaced by the manufacturer, its service agent or similarly qualified persons in order to avoid a hazard.
5. Before operating this system, check the voltage of this system to see if it is identical to the voltage of your local power supply.
6. The unit should not be impeded by covering the ventilation opening with items such as newspaper, table-cloths, curtains etc. Make sure that there are at least 20 cm of space above and at least 5 cm of space on each side of the unit.
7. The apparatus must not be exposed to dripping or splashing liquid, no objects filled with liquids such as vases, should be placed on the apparatus.
8. To prevent fire or shock hazard, do not expose this equipment to direct heat, rain, moisture or dust.
9. Do not position this unit near any water sources e.g. taps, bathtubs, washing machines or swimming pools. Ensure that you place the unit on a dry, stable surface.
10. Do not place this unit close to a strong

magnetic field.

11. Do not place the unit on a amplifier or receiver.

12. Do not place this unit in a damp area as the moisture will affect the life of electric components.

13. Do not attempt to clean the unit with chemical solvents as this might damage the finish. Wipe with a clean, dry or slightly damp cloth.

14. When removing the power plug from the wall outlet, always pull directly on the plug, never pull on the cord.

15. Depending on the electromagnetic waves used by a television broadcast, if a TV is turned on near this unit while it is also on, lines might appear on the LED TV. Neither this unit nor the TV is malfunctioning. If you see such lines, keep this unit well away from the TV set.

16. The mains plug is used to disconnect the device, the disconnected device should remain readily operable.

### **Important Safety Instructions**

1. Read these instructions. Keep these instructions. Follow all instructions. Heed all warnings.

2. Do not use this apparatus near water.

3. Clean only with dry cloth.

4. Do not block any ventilation openings. Install in accordance with the manufacturer's

instructions.

5. Do not install near any heat sources such as radiators, heaters, stoves, or other apparatus (including amplifiers) that produce heat.

6. Protect the power cord from being walked on or pinched particularly at plugs, convenience receptacles or at the point where they exit from the apparatus.

7. Only use attachments/accessories specified by the manufacturer.

8. Unplug this apparatus during lightning storms or when unused for long periods of time.

9. Refer all servicing to qualified service personnel. Servicing is required when the apparatus has been damaged in any way, for example, when the power-supply cord or plug is damaged, liquid has been spilled or objects have fallen into the apparatus, the apparatus has been exposed to rain or moisture, does not operate normally, or has been dropped.

10. The AC plug is used to disconnect the device, the disconnected device should remain readily operable. In order to disconnect the apparatus from the AC power completely, the AC plug must be removed from the AC outlet completely.

### **Important Notes**

- Safety and operating instruction manual should be retained for future reference.

- The apparatus should not be exposed to dripping, splashing or placed in a humid atmosphere such as a bathroom.
- Do not install the product in the following areas:
  - Places exposed to direct sunlight or close to radiators.
  - On top of other stereo equipment that radiate too much heat -Blocking ventilation or in a dusty area.
  - Areas where there is constant vibration.
  - Humid or moist places.
  - Do not place near candles or other flames.
- Operate the product only as instructed in this manual.
- Before turning on the power for the first time, make sure the sound bar is plugged to power outlet.
- For safety reasons, do not remove any covers or attempt to gain access to the inside of the product. Refer any servicing to qualified personnel.
- Do not attempt to remove any screws, or open the casing of the unit; there are no user serviceable parts inside. Refer all servicing to qualified service personnel.

### **Power Source:**

This soundbar is designed to operate in DC 24V == 1.25A.

# Product Representation

## Sound Bar & Sub-Woofer

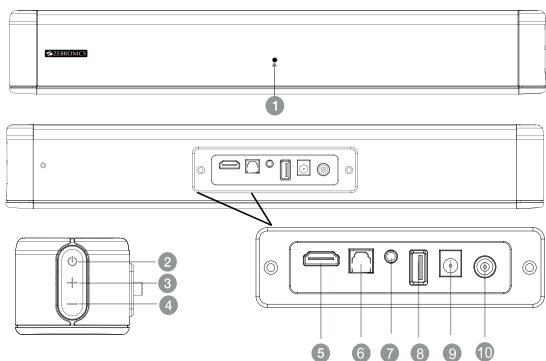



1. LED indicator
2. STANDBY/POWER
3. VOL+
4. VOL-
5. HDMI (ARC)
6. OPTICAL
7. AUX
8. USB
9. DC IN
10. SUB OUT
11. SW SPEAKER OUTPUT

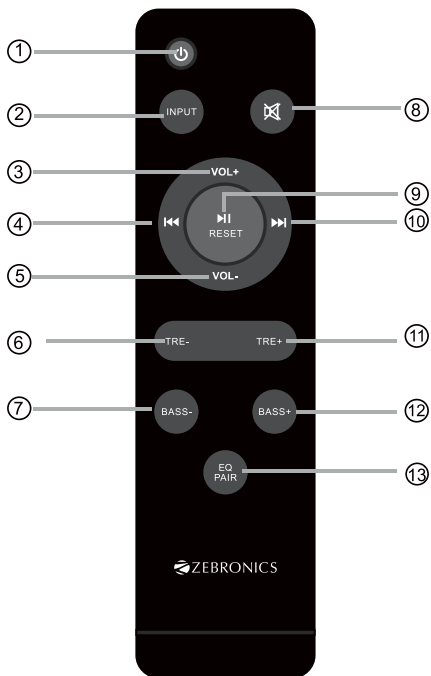

## Remote Control



1.  : Standby mode for power on/off.
2. INPUT : Input mode Selection.
3. Vol+ : Volume Increase.
4.  : Previous Track (Only work under USB & BT Mode).
5. Vol- : Volume Decrease.
6. TRE- : Treble Decrease.
7. Bass- : Bass Decrease.
8. Mute : Mute Mode.
9.  / RESET

Play/Pause : Play / Pause for Current Track (Only work under USB and BT mode).

Reset : Press and hold the button more than 2 sec. to Set all functions to manufacturer defaults.

10.  : Next Track (Only work under USB & BT mode).
11. TRE+ : Treble Increase.
12. BASS+ : Bass Increase.
13. EQ/PAIR

EQ : Press in one time for one mode of EQ. Music/Movie/News/Sport total four modes when circulate press the button in short time.

Pair : Press and hold more than 2 sec. to disconnect paired BT device. Press and hold more than 2 sec. to connect back last disconnect BT device.

## Positioning the Sound Bar

### Place on a flat Surface

Place the sound bar horizontally on a flat surface such as a TV unit or shelves and align it centrally with the TV screen. Allow some space between the speaker and the wall. Don't place inside a cabinet or an a walled shelf. Follow this guidance for best sound output and good airflow around the sound bar.

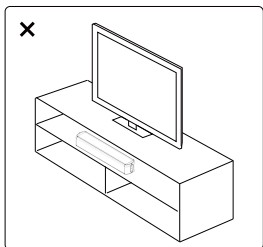
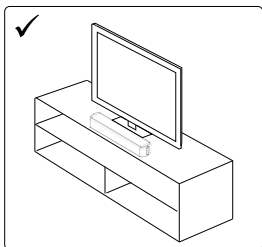

### Mount on the wall

**WARNING :** If you don't feel confident to correctly and securely wall-mount the sound bar, Seek the assistance of an experienced person of professional.

Install the speaker on a vertical, fast, reinforced area of wall. For plaster walls, it is recommended to screw into wall studs for greater security. For optimum performance, allow at least 25mm/1" distance between the sound bar and the TV.

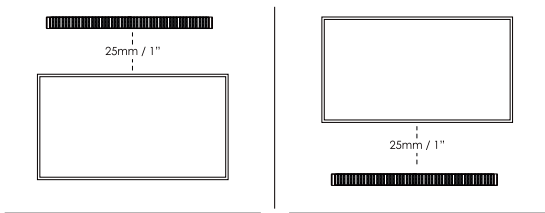

## **Follow below steps to mount the sound bar on the wall**

1. Paste 2 pieces of EVA foam (with holes) on the two wall brackets aligning at the hole position of wall brackets.
2. Remove 4 screws from the rear housing of sound bar, then insert the 4 screws over the wall bracket screw holes aligning (on the side of EVA foam pasted), and then fasten the screws again.
3. According to the two hanging wall positions on the rear of soundbar, calibrate and mark the two hanging brackets hole position on the wall. Then drill two holes on the wall, firstly insert two expansion plastic screws on the wall, then fasten the hanging screws into expansion screw holes.
4. Then Paste the 2 pieces of EVA foam (without holes) on the two wall brackets downward. Then place the hollow cross in the center of the bracket against the screws on the wall and hang the sound bar on the wall finally.

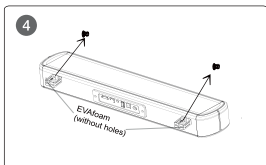
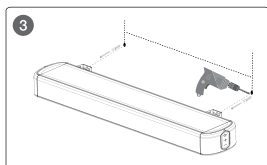
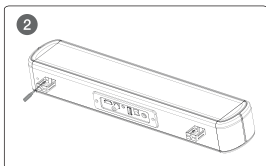
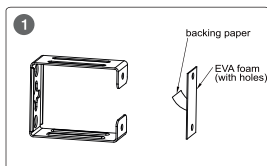

## OPERATE INSTRUCTIONS

### Setting the Soundbar

1. Plug the power cord in and the LED will light up.
2. Press the power/standby button either in soundbar or remote control to select the mode you need with the remote controller. The indicator can change to different colors, representing different states:

Blue	: BT Mode
Green	: AUX Mode
Cyan	: HDMI (ARC) Mode
Orange	: Optical mode
Pink	: USB Mode

### Powering On/Off

1. Plug the sound bar adapter into a wall outlet, it will automatically enter standby mode.

2. Short-press the power/standby button either in soundbar or remote control to turn on the soundbar.
3. To turn off, press either the STANDBY button on remote control or soundbar or unplug from wall outlet.

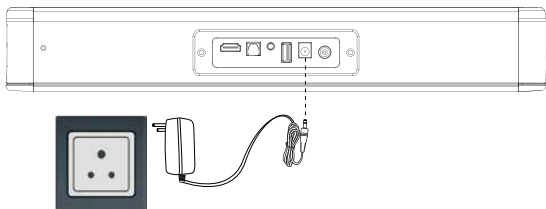

### Playing Audio via BT Connection

1. Use "**Input**" button on the remote to activate BT mode. A Blue LED indicator will indicate that BT mode has been selected.
2. Activate the pairing function on your phone or other compatible device and select "**ZEB-JUKE BAR 4050**".
3. When successfully paired, you will hear a tone and the LED will stay on.
4. The remote control includes BT mode playback controls.

#### Notes:

- If your pairing device is switched off or manually disconnected, the sound bar will automatically enter pairing mode.
- If the connected device is switched off or manually disconnected, the sound bar will automatically enter

*pairing successfully connected device will be re-established once you re-enter wireless range(10 meters). to connect to other devices, repeat the above pairing steps*

*• There is no automatic shutdown in pairing mode. The sound bar will remain in pairing mode even if no device is paired, so switch off if not in use*

## **Playing Audio via USB Port**

When the USB flash drive is plugged in, the sound bar automatically switches to USB input mode. A Pink LED indicator will indicate that USB mode has been selected. This mode cannot be selected on the sound bar or remote control unless it is connected to a USB flash drive.

1. Ensure that your USB flash drive contains MP3 audio files (other file types not supported).

2. Connect the USB flash drive to the USB port on the sound bar (or your own USB extension cable connected to the USB port); music will automatically play.

3. The remote control includes USB input mode playback controls.

## Using the Soundbar

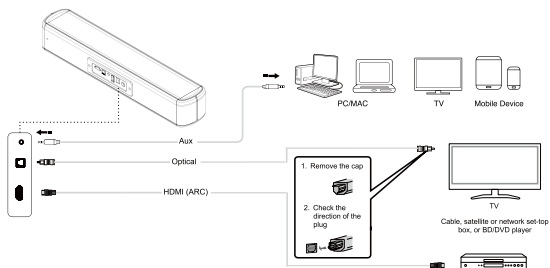

### Audio input(Aux)Connection

1. Use the "Input" button on the remote to activate AUX mode. A green LED indicator will indicate that AUX mode has been selected.
2. Playback functions (play/pause, tracks, pair) cannot be adjusted through the SoundBar remote when in AUX mode.

**Note:** For some computers, you may need to access the audio control panel to manually set the sound bar as below picture.

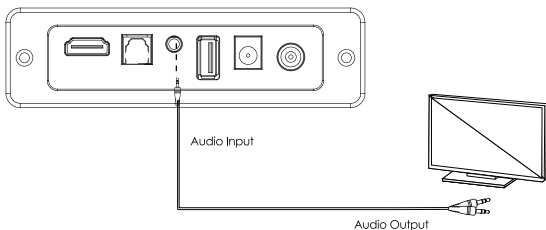

### HDMI (ARC) Mode

1. Use the "Input" button on the remote to active HDMI(ARC) mode. A Cyan LED indicator



will indicate that HDMI(ARC) mode has been selected.

2. The Soundbar supports HDMI with Audio Return Channel(ARC). If your TV is HDMI ARC compliant, you can hear the TV audio through your Soundbar by using a single HDMI cable

3. Using a High Speed HDMI cable, connect the HDMI (ARC) connector on the soundbar to the HDMI ARC connector on the TV. The HDMI ARC connector on the TV might be labelled differently. For details, see the TV user manual.

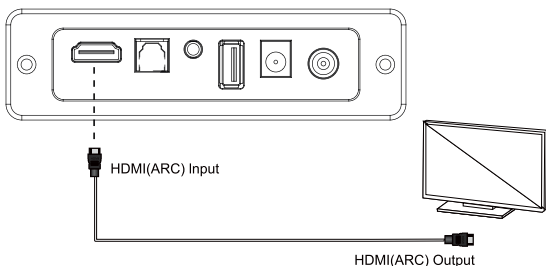

## Optical Mode

1. Use the "**Input**" button on the remote to active Optical mode. An orange LED indicator will indicate that Optical mode has been selected.

2. Playback functions (play/pause, tracks, pair) cannot be adjusted through the SoundBar remote when in Optical mode.

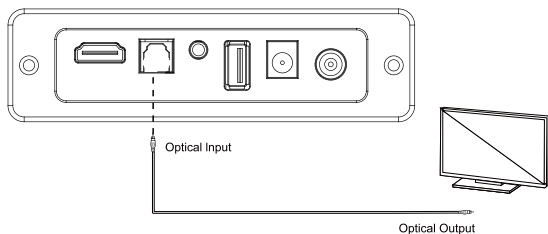

## Features:

Wireless BT/USB/AUX/OPTICAL IN/HDMI (ARC)

11.43 cm Subwoofer

Remote Control

LED Indicator

Volume/Media Control

Wall Mountable

Compact Sound Bar with Dual Drivers

External Power Adapter

## Specifications

Output Power

Subwoofer : 45W

Soundbar : 15Wx2

Total : 75W

Driver Size

Subwoofer : 11.43 cm

Soundbar : 5.2cm x 7.5cm

Impedance

Subwoofer : 6 $\Omega$

Soundbar : 4 $\Omega$  x 2

Frequency response : 60Hz-20kHz

S/N Ratio :  $\geq$ 66dB

Separation	: ≥40dB
File format support	: MP3 (USB)
Line input	: 3.5mm, Optical IN, HDMI (ARC)
Max supported memory size (USB)	: 32 GB
BT name	: ZEB-JUKE BAR 4050
BT version	: 5.0
Product Dimension (W x D x H)	
Subwoofer	: 100 x 185 x 355 mm
Soundbar	: 410 x 75 x 64 mm
Net. Weight	
Subwoofer	: 1.65 kg
Soundbar	: 800 g
Total	: 2.45 kg

## Troubleshooting

PROBLEM/TROUBLE	POSSIBLE CAUSE	SOLUTION
There is no sound output from sound bar.	Another input source is selected.	Select an appropriate input source.
	The mute function is activated.	Cancel the mute function.
	The volume of sound bar or TV/other device is adjusted too low.	Increase the volume level on sound bar or by remote control or on TV.
	The power cable of the unit is not connected properly.	Make sure that the power cable of the unit is connected to an AC wall outlet securely.
	Input jacks on a playback device are connected.	Connect the input jack on the sound bar and the output jack on the playback device.
	Signals that the sound bar cannot playback when being input.	When sound bar and TV or other devices are connected by an audio cable through TV (ARC) port output, Select the correct audio input and output. Make sure the digital audio output setting on the playback device to PCM format. Since the output format of our sound bar is PCM, if it is used, the decoding format of TV or other devices will be adjusted to PCM state.
The sound is distorted or echoed.	TV volume is not muted.	If you play audio from TV through the sound bar, make sure that the TV is muted.
The volume decreases when the unit is turned on.	The automatic volume adjustment function is activated. To prevent excessive loudness, the unit automatically controls its volume within a certain level when the unit is turned on.	Turn up the volume as required.
Noise is heard.	The sound bar is too close to another digital or high-frequency device.	Move those devices away from the sound bar.
The unit cannot be operated by using the remote control.	The unit is out of the operating range.	Use the remote control within the operating range.
	The batteries are weak.	Replace with new batteries.
	The remote control sensor of the sound bar is exposed to direct sunlight or strong lighting.	Adjust the lighting angle or reposition the sound bar. Make sure our product cannot be used in sunlight.

PROBLEM/TROUBLE	POSSIBLE CAUSE	SOLUTION
The TV cannot be operated by using the TV's remote control.	The unit is blocking the TV's remote control sensor.	Position the unit so that it does not obstruct the TV's remote control sensor.
A device cannot connect the sound bar or the unit cannot be connected to a Bluetooth device.	Bluetooth function of the device is not activated, not paired or connected correctly.	Restart the sound bar and try pairing again. You have not enabled the Bluetooth function of the device; see the user manual of the device on how to enable the function and correctly connected the device. The sound bar is already connected with another Bluetooth device. Disconnect the connected device, and then try again.
	Bluetooth is not selected as the input source.	Select Bluetooth as the input source.
	The unit is connected to a different Bluetooth device.	Un-pair the Bluetooth device that is currently connected and pair with the desired Bluetooth device.
	The unit is too far away from the Bluetooth device.	Move the Bluetooth device closer to this unit.
	A device emitting electromagnetic waves (such as a microwave oven, a wireless device and so on) may be placed nearby.	Do not use this unit near devices that emit electromagnetic waves.
	The Bluetooth device that you are using may not support the protocol.	Use a Bluetooth device that supports the protocol.
	The connection profile registered in the Bluetooth device may not be functioning correctly for some reason.	Delete the connection profile in the Bluetooth device and then connect the Bluetooth device to this unit.
Sound quality of audio play from a connected Bluetooth device is poor and connection is not stable.	The Bluetooth reception is poor.	Move the device closer to the sound bar, or remove any obstacle between the device and the sound bar.
No sound can be heard or sound breaks (Bluetooth mode)	The volume on the Bluetooth device may be too low.	Raise the volume on the Bluetooth device.
	Bluetooth is not selected as the input source.	Select the Bluetooth as the input source.
	Playback on the device has not been performed.	Perform playback on the device.
	The sound output on the Bluetooth device may not be set to this unit.	Select this unit as the output device on the Bluetooth device.
	The connection to the Bluetooth device was cut off.	Connect with the Bluetooth device one more time.
	The unit may be too far away from the Bluetooth device.	Move the Bluetooth device near this unit.
	A device emitting electromagnetic waves (such as a microwave oven, a wireless device and so on) may be placed nearby.	Do not use this unit near device that emit electromagnetic waves.
There is no sound from sound bar - HDMI TV (ARC) Mode	No qualified HDMI TV (ARC) cable is used & No signal is input on sound bar & connection and operation method is not correct.	1. Make sure that the user connected TV and sound bar by a 19-core HD ARC cable. 2. The sound bar and TV are connected through TV (ARC) port output; make sure that the TV is ARC compliant. 3. Set the TV to HDMI ARC (CEC). Set the audio output mode of TV to PCM format. (Or refer to your TV user manual)
There is no sound from sound bar (OPTICAL Mode)	OPTICAL cable maybe damaged & No signal is input on sound bar & connection and operation method is not correct.	1. Replace the OPTICAL cable with a new one to connect. 2. Set your TV audio output to PCM format. (Pls refer to your TV user manual)
There is no sound from sound bar (USB mode)	USB file type is not support & Sound bar doesn't switch to USB input mode automatically when USB is inserted.	Make sure that USB flash drive contains MP3 files because other file types are not supported. Switch the input mode once again, then playback again.

**ISO 9001:2015 Certified Company**  
**www.zebronics.com**