



RO SYSTEM  
WATER YOU CAN TRUST

#### WHIRLPOOL OF INDIA LIMITED

CORPORATE OFFICE: PLOT NO. 40, SECTOR - 44, GURGAON - 122002

For inquiries, please call us at: 18601804558 (For BSNL & MTNL Landline Subscribers)  
or 60008558 (For other Subscribers). Please pre-fix your STD Code.

Visit us  [www.whirlpoolindia.com](http://www.whirlpoolindia.com)



## USE AND CARE GUIDE

Purafresh RO

Happiness begins at home



**Contents**

Welcome to the Whirlpool Family ..... 2

Getting to know your Whirlpool RO ..... 3

What makes your Whirlpool RO special ..... 4

How does it work..... 5

Safety Precautions..... 6

Easy steps for installing your Whirlpool RO ..... 7

How to maintain your Whirlpool RO ..... 9

How to clean your Whirlpool RO ..... 10

Do's and don'ts while using ..... 12

When moving house or before going on vacations ..... 17

Troubleshooting..... 18

Warranty Card ..... 19

Warranty Terms and Conditions ..... 20

Installation Report ..... 21

Frequently Asked Questions ..... 22

Whirlpool Service ..... 23

Technical Specifications..... 24

Water Purifier (RO) Disposal ..... 25

## Welcome to the Whirlpool Family



Dear Homemaker,

Congratulations on bringing home the new Whirlpool RO System. We would like to welcome you to the global fraternity of Whirlpool homemakers who believe in giving their families nothing but the best.

You would be proud to know that Whirlpool is the largest home appliance company in the world and that a Whirlpool appliance finds a new home in some part of the world, every two seconds. This has been possible because homemakers like you choose Whirlpool and reinforce our belief in Innovation, Operational and Customer Excellence. Our RO system are elegantly styled and convenient to use. They promise you premium quality and fill your life with the magic of Whirlpool. To get the best out of your RO system, use this simple and easy to understand guide and follow the instructions. We would love to assist you with your queries and suggestions at the Whirlpool Home Care Centre number mentioned in this user guide or at [www.whirlpoolindia.com](http://www.whirlpoolindia.com).

We wish you years of joyful homemaking with your Whirlpool RO system and look forward to having a great relationship with you.

Your Sincerely

Rajiv Kapur

Vice President-Marketing

## Getting to know your Whirlpool RO

Whirlpool RO system is tested to Indian drinking water standards IS: 14543. All internal filters of Whirlpool® RO System are high capacity, high performance and easily replaceable. It has 6-stages\* incorporating RO membrane technology and Mineral Enrichment System (MES) to keep water pure and fresh.

### All about Whirlpool RO

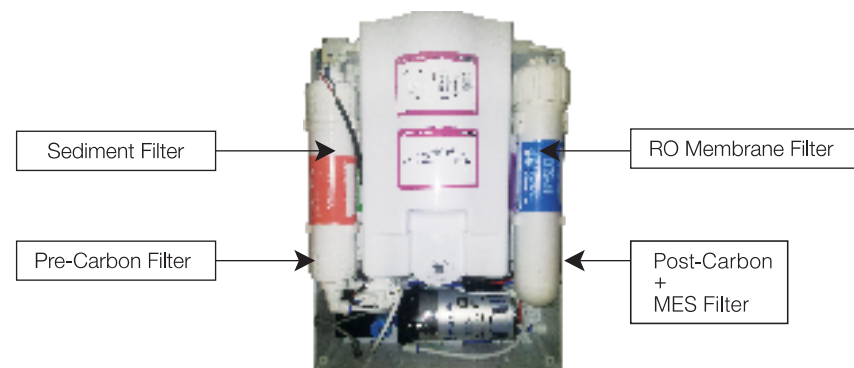

Front



Rear



\* in selected models with Pre-Filter assembly

# What makes your Whirlpool RO special

## Features



### MES FILTER

Ensures that the water you drink is enriched with essential minerals like calcium, magnesium, sodium etc. It also helps to maintain the optimum pH level giving you water that is tasty and healthy.



### LARGE STORAGE TANK

Storage tank of 8.5 Litres adequate for servicing the need of large family.



### 6 STAGE PURIFICATION

This RO System has 6 stage\* purification thereby ensuring best in class performance.

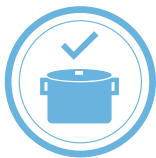

### INTERNATIONAL FOOD GRADE MATERIAL

The internal parts of the product are made up of international food grade material.



### TESTED FOR INDIAN DRINKING WATER STANDARD

The product has been tested for IS:14543 Indian Drinking Water Standards.

\* in selected models with Pre-Filter assembly

## How does it work

### 6 Stages of Purification Process

Stage No.	Filtration	Benefit
1*	Pre-Filter	Acts as a first line of defense to remove sediment particles.
2	Sediment Filter	Reduces insoluble particles from feed water and protects membrane and pre-carbon filter from being plugged.
3	Pre-Carbon Filter	Reduces aesthetic chlorine, odor, volatile organic compounds (VOC's).
4	RO Membrane Filter	Reduces water contaminants such as pentavalent arsenic, barium, cadmium, selenium, radium 226/228, trivalent chromium, hexavalent chromium, lead, nitrate/nitrite.
5+6	Post-Carbon + MES Filter	Reduces smell induction material, aesthetic chlorine and volatile organic compounds (VOC's) and improves taste of water.

\*in selected models

## WATER FLOW DIAGRAM

Minerala 90

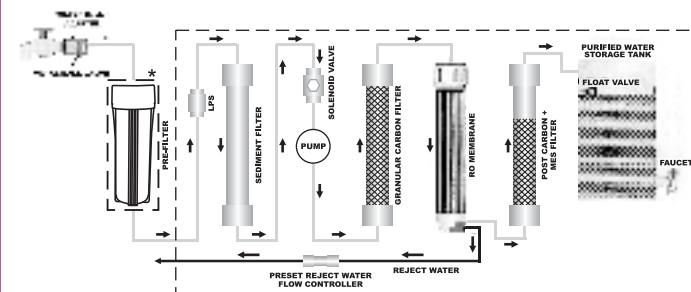

\*in selected models

## Safety Precautions

### Your safety and safety of others are very important.

We have provided many important safety messages in this manual and on your appliance.

- Please read all safety and operating instructions before operating the appliance.
- Please retain this manual at all times for reference.
- All warnings, cautions and notes on Whirlpool RO are important; please pay attention to them.
- For best result, follow the instructions given in this manual.
- Include both the model number and the serial number while corresponding with Whirlpool or your dealer in connection with this product.



This is the safety alert symbol, it alerts you of hazards that can hurt you and others.

All safety messages will be preceded by the safety alert symbol and the word "DANGER" or "WARNING"

#### **⚠ DANGER**

You can be killed or seriously injured if you don't follow the given instructions.

#### **⚠ WARNING**

You can be killed or seriously injured if you don't follow the given instructions. All safety messages will identify the hazard, tell you how to reduce the chance of injury, and tell you what can happen if the instructions are not followed.

## Easy steps for installing your Whirlpool RO

### Preparation Before Use

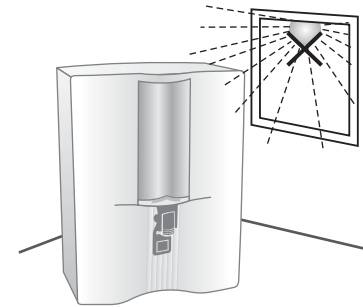

Install it in a dry, ventilated place.

- Keep it away from direct sunlight or from freezing temperatures.

Connect it to cold tap water only.

- Filters can be damaged if connected to hot tap water.
- Make sure that the tap water pressure is between 4 psi and 60 psi

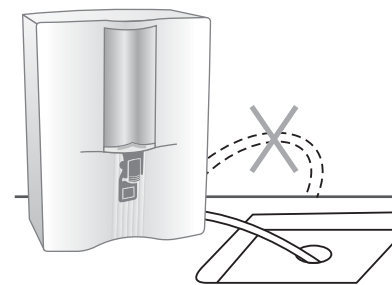
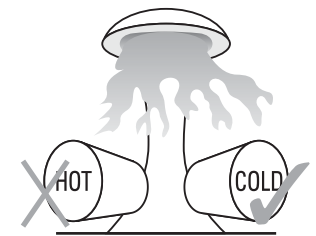

Make sure that the reject water tubing is placed at the bottom of the purifier.

If not, water might flow back into the purifier.

- Make sure that the purifier is installed within the distance of 5 m from the tap water supply.
- This purifier is for 230V only so make sure that you connect to a 230V power outlet.
- Do not install the purifier in a place where water or rain could leak into it (Outdoor etc.).

## Easy steps for installing your Whirlpool RO

### Installation

#### Step1 Open the valve to supply water to the Whirlpool RO.

Before using the product, flush two filters (Sediment Filter, Pre-Carbon Filter).  
Filter Flushing

##### a. Procedure of Filter Flushing

Sediment Filter-Flushing → Pre-Carbon Filter → Flushing

##### b. Flushing Method – Sediment Filter

(1) Remove the tubing on the back of Sediment filter

(2) Clean the Sediment filter with the feed water for about three minutes

##### c. Flushing Method – Pre-Carbon Filter

(1) Remove the tubing on the back of Sediment filter

(2) Connect the Post-Carbon filter to the back of Sediment filter

(3) Clean the Pre-Carbon filter with the feed water that passed the sediment filter for about three minutes

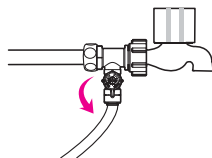

#### Step2 To Open the front cover

a. Rotate the tap anti-clockwise

b. Unscrew, 4 nos of screws at the back cover

c. Open the front cover

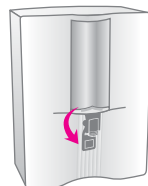

#### Step2 Install the RO membrane

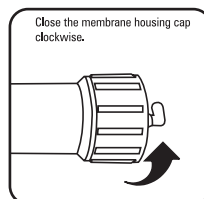
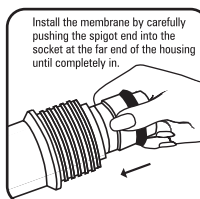
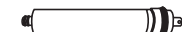

#### Step3 Check the unit to ensure no water leakage before connecting the power supply.

#### Step4 Wall-mount your Whirlpool RO on two (2) positions 1&4.



#### Step5 Only connect the power cord of the voltage rating that matches with that on the rating plate. Do not plug or unplug the power cord with wet hands. Please ensure that the plug isn't wet to avoid risks such as electric shock or fire.



#### Step6 Flush the first 2 tank-full of pure water. This flushes the membrane, filters and tank for first time use.

## How to maintain your Whirlpool RO

### Estimated Life of Filter

The estimated life of filter which is a consumable part, is not an indication of quality guarantee period. It indicates the period for which the filter shall work to its full ability. The estimated time of filter replacement may be shortened in case it is used in the area of poor water quality or increased if the water quality is better.

Names of Filter	Usable Period
Sediment Filter	6 months
Pre-Carbon Filter	6 months
RO Membrane Filter	12 months
Post-Carbon+MES Filter	12 months

- Basis usage of 15 Liters water per day with maximum feed water TDS up to 2 000 ppm.
- Filter replacement period would vary depending on usage & TDS level of the feed water.
- Whirlpool is not responsible for any problem caused by using unauthentic filters and/or parts.

### Important to Note

#### a) Timely filter replacement

- Each and every filter in the product has a specific task to perform and hence it is essential to ensure timely replacement of these filters so that the product functions well.
- It is also important to replace the filters at their due time so that the other filters like RO membrane do not get choked before time.

#### b) Regular Preventive visits

- Preventive maintenance of the product is a must to ensure longevity and consistent performance with less breakdowns. Whirlpool in the first year of purchase provides 2 preventive maintenance visits free to the customer.

#### c) Genuine Filters

- It is essential to use genuine Whirlpool filters. This ensures consistent product performance.
- All internal filters of the product are of international quality.
- All internal filters of the product come with a sealed casing so as to ensure that no spurious material can be put inside the casing thereby assuring consumers of best quality.

### How to use

#### Drink the filtered water

Push the paddle dispenser with cup or drinkware.

#### Continuous dispensing

Lift up the paddle dispenser and fix it. The water will be dispensed continuously.



#### Caution Note :

Do not pull out the cup-touch lever severely to avoid damage or breakage.

## How to clean your Whirlpool RO



### WARNING:

Keep the surrounding environment clean all the time and clean the inside of the tank once in 15 days to get clean water.

- Step1** Unplug the power cord to turn off the power supply.

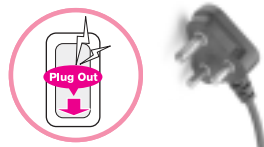

- Step2** Close the feed water supply valve. Drain all the water inside the water tank by continuous dispensing. Store the water in bucket or a bowl.

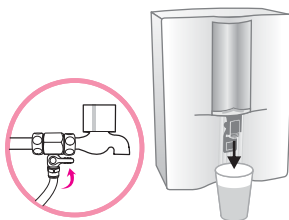

- Step3** Push up the tap lever to drain the reservoir water. Open the top cover.



- Step4** Wipe the inside of water tank with a clean soft cloth. Wipe the inside of the tank with a soft cloth.

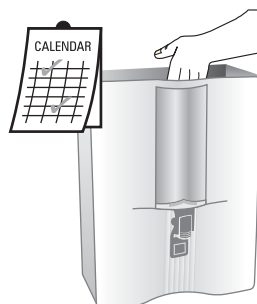

## How to clean your Whirlpool RO

- Step5** Close the top cover lid. Plug in the power cord.

- Step6** Open the feed water supply valve. Flush/run the purified water for 30 minutes before re-using the purifier.

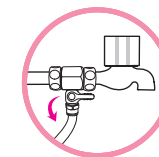

### CAUTION !!

Do not pull or push the water dispensing lever with excessive force. The lever might break.

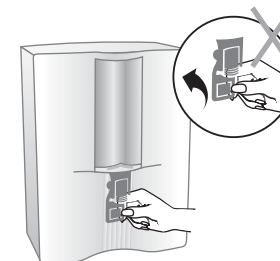

### CAUTION !!

Do not use a strong detergent, chemical material when using or cleaning the storage tank.

### ⚠ WARNING

#### Explosion Hazard

- Use non-flammable cleaners.
- Failure to do so can result in death, explosion or fire.

Detergent Chemical Materials





## Do's and don'ts while using



### Caution Note :

For your safety, the information in this manual must be followed to minimize the risk of property damage or personal injury.



## Electrical Safety

- Connect the power cord of the voltage rating that matches with that on the rating plate. To avoid electric shock, do not plug or unplug the power cord with wet hands. Ensure that the plug isn't wet to avoid risks such as electric shock or fire.

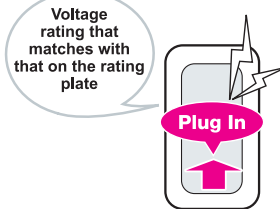

- Do not pull the power cord from the outlet with wet hands or wet the plug



- To avoid any electric leakage or damage, do not bend the power cord by force and do not put a heavy object on it.

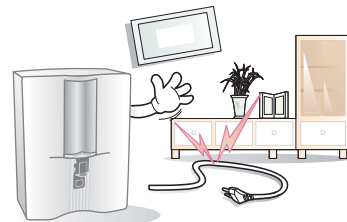

## Do's and don'ts while using

- To avoid any risk of electric shock, never splash the filtration system with water.

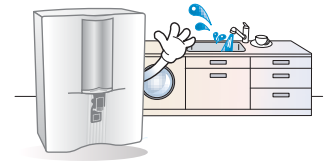

- Keep the cord away from wiring conjunctions areas to avoid fire hazard, NEVER put the cord under rugs, near heat resistors, radiators, stoves, or heaters.

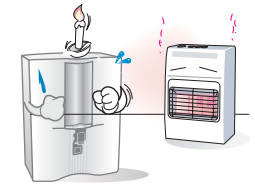

- Do not use a damaged power cord or plug or loose connection where the plug cannot be inserted securely to avoid fire or shock hazard. If the power cord is damaged, it must be replaced by the manufacturer or its service agent or a similarly qualified person in order to avoid a hazard.

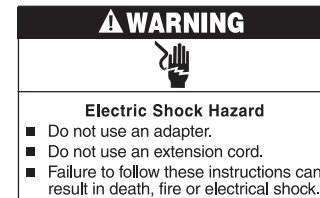
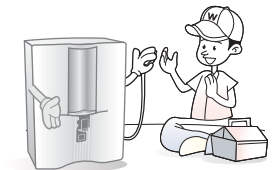

- Unplug the power cord when not using for an extended period of time. Insulation may deteriorate causing short circuit, fire and/or electrical shock.

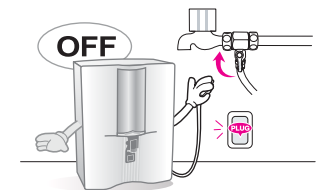

- Use a dry cloth and regularly clean the dust from the power plug. Accumulation of dust can cause bad insulation which may result in a fire hazard.

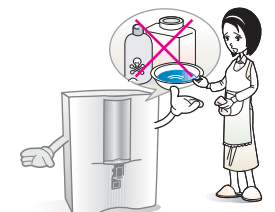



## Do's and don'ts while using



### Installation & Use Safety

- Keep the water filtration system away from direct sunlight. The sun's heat may deform non-metallic parts and damage the electronics. It may lead to discolouration /fading of plastic parts.

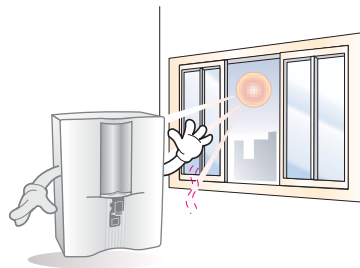

- Do not install water filtration system where it could freeze. Freezing damage is not covered by the warranty.

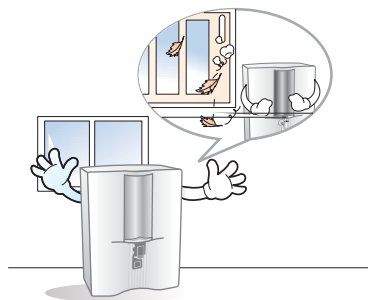

- Keep the water filtration system away from humid and dusty places in order to avoid electric shock and fire.

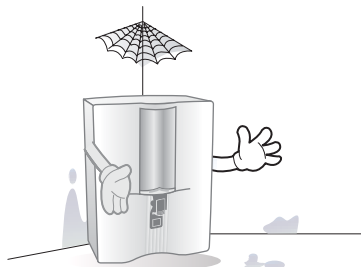

## Do's and don'ts while using

- If the pressure of water in the house is over the maximum working pressure (60 psi) of the water filtration system, then install a pressure reducing valve in the water supply line.

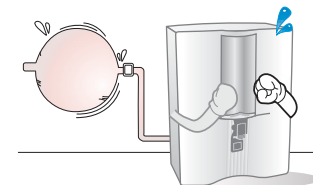

- Water filtration system should be connected to portable water pipe only. Do not run hot water over 45 °C through it. It will damage the filters of the water filtration system.

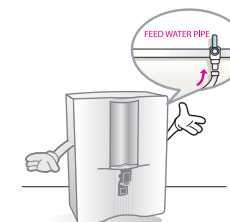

- Periodical filter replacement is a prerequisite for getting clean water. In case filters are overused, the performance of filters deteriorates regularly. Therefore, do not forget to replace the filters.

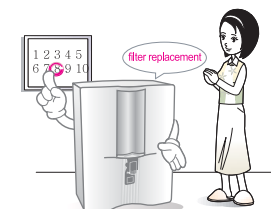

- When the product is not in use for a long time, drain all the water in the storage tank before use.

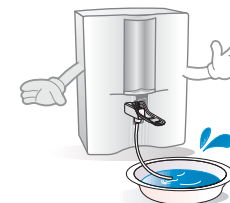

- Do not repair, disassemble, or modify any part of filtration system on your own. Fire and/or electric shock may occur as a result. For repair, contact your dealer or Whirlpool Service.

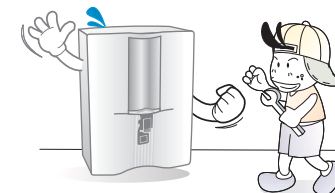

## Do's and don'ts while using

- Do not allow any foreign material to get into the storage tank. The filtered water in the storage tank may contaminate as a result.



- In case of smoke or smell of fire immediately remove the plug of the filtration system from the socket and call Whirlpool service. Electric shock or fire may occur as a result.

⚠ WARNING	
	
<b>Electric Shock Hazard</b>	
■	Do not use an adapter.
■	Do not use an extension cord.
■ Failure to follow these instructions can result in death, fire or electrical shock.	

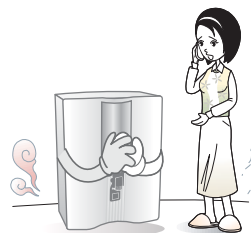

- In case of any water leakage, lock feed water valve and plug out and call Whirlpool Service.

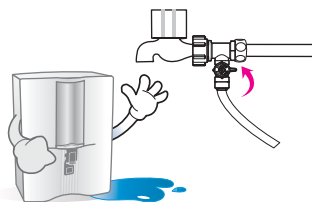

- This appliance is not intended for use by persons (including children) with reduced physical, sensory or mental capabilities, or lack of experience and knowledge, unless they have been given supervision or instruction concerning use of the appliance by a person responsible for their safety.

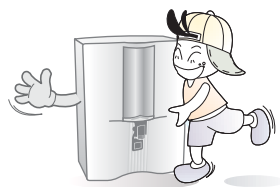

- Children should be supervised to ensure that they do not play with the appliance.

## When moving house or before going on vacations

### Before shifting

- Before shifting, get the RO System duly inspected and packed by Whirlpool Service.
- This will not only keep the RO System safe while shifting but is also necessary for continuation of warranty. The packing charges will be as per prevailing rates.
- Switch off the power supply & disconnect the power cord.
- Remove all loose shelves and tape them in cardboard boxes.

### When going on a vacation

- When not in use or when you are going on a vacation (for more than a week), remove the plug from the socket and disconnect the power cord.
- Unplug the power cord to turn off the power supply.

## Proper disposal of your old RO System

Abandoned RO System are dangerous even if they are left unattended for a few days.

If you are getting rid of your old RO System, please follow these instructions to prevent accidents.

### Before you throw away your old RO System.

- Take out all the connections.
- Remove the filters from the unit so that they can't be reused.

## Troubleshooting

Problems	Self-Check	Remedial Measures
<b>Unusual taste of water</b>	Have you cleaned the storage tank?	Clean the storage tank.
	Have you stored the water for too long?	Drain the stored water and clean the storage tank.
	Is it time to replace the filter?	Replace the filter.
<b>The amount of filtered water has suddenly increased or decreased</b>	Did you close the feed water valve?	Check the feed water valve.
	Does the temperature of the feed water drop dramatically?	If the water temperature lowers, the amount of filtered water reduces.
	It looks that the filter is blocked or damaged.	Replace the filter.
<b>Water isn't flowing out</b>	Is the suspension of water supply or the feed water valve closed?	Open the feed water valve.
	It looks that the faucet is out of order.	Ask for Whirlpool Service.
	Have you missed the time of filter replacement?	Replace the filter.
<b>When all functions come to a halt while operating</b>	Is the feed water supplied smoothly?	Check the feed water valve.
	Is the filtered water overflowing or leaking?	Ask for Whirlpool Service.

- Filter is the heart of the water filtration system. So, it is essential to use authentic filters only.
- In case you do not use authentic filters or neglect proper maintenance of the filtration system, it can reduce the life of the RO System.
- Please contact Whirlpool Service or dealers for authentic filters/filter replacement.

## Warranty Card

### Whirlpool RO System Warranty Registration Card

#### Minerala 90 Platinum

Serial No. \_\_\_\_\_ Model No. \_\_\_\_\_

Date of Purchase \_\_\_\_\_

Purchaser's Name \_\_\_\_\_ Tel. No. \_\_\_\_\_

Address \_\_\_\_\_

Dealer's Name \_\_\_\_\_ Tel. No. \_\_\_\_\_

Address \_\_\_\_\_

\_\_\_\_\_  
Dealer's Signature  
(with rubber stamp)

Note:

1. Please retain the bill of purchase.
2. Please quote Serial number, Model & Date of purchase in all your correspondence.

\_\_\_\_\_  
*WHIRLPOOL OF INDIA LIMITED (WOIL) warrants to the purchaser of the Whirlpool RO System, provided the RO System continues and remains in the possession of and used by the purchaser, as from the date of purchase.*

*RO System WARRANTY FOR ONE YEAR*

*WOIL's obligation under the warranty shall be limited to remove the defect & make the product functional by repair or replace of a defective part with a functional part in respect of the said RO System product within one year from the date of original purchase and which on WOIL's examination discloses to its satisfaction to be defective.*

# Warranty Terms and Conditions

Whirlpool of India Limited (WOIL) warrants to the original domestic purchaser of this RO System that it is free from defects in material and workmanship.

**Limitation of warranty**

1. The warranty does not cover:

(i) Defects caused by rough handling (including, without limitation, defects caused by sharp items, by bending, compressing or dropping, etc),

(ii) Defects or damage caused by misuse of the product, including use that is contrary to the instructions provided by WOIL (e.g. as set out in the Product's user guide) and/or

(iii) Other acts beyond the reasonable control of WOIL.

(iv) Plastics parts Cosmetic damage or exterior finish.

(v) Consumable Component such as all filters excepting reverse osmosis membrane . The reverse osmosis membrane will be covered for any damage, malfunctioning under warranty maximum for one year, effective from the date of purchase.

(vi) The warranty on the reverse osmosis membrane will be applicable only

a. If the input TDS at the time of installation is maximum up to 2500 ppm

b. If due preventive maintenance is carried out and sediment filter & pre carbon filter are replaced as per recommended schedule

c. The warranty on RO membrane is against defects and not as a result of misuse. The Warranty applicability is subject to strict adherence to the prescribed usage pattern as provided in the user manual

2. This warranty does not apply, where the defect or fault is caused or contributed by:

(i) Improper installation by the purchaser himself or non adherence of the specific installation instructions either supplied within each product box or carton or available on the WOIL website or through the authorized dealer or WOIL's representative; or

(ii) Use of the product in a manner or for a purpose for which it was not designed.

(iii) If damage is caused by accidents, abuse, neglect, fire, water, lightning or other acts of nature.

(iv) If damage is caused by improper electrical connection.

(v) If the product is repaired by any person/institution other than the authorized service centre or personnel specifically assigned for the said purpose.

(vi) If the serial number on the product is defaced, missing or altered.

(vii) If the damage is caused by pest infestation.

(viii) If the water purifier is used for commercial purposes.

(ix) If the unit is not cleaned as instructed in the manual.

(x) If the input water emits pungent smell.

3. Our staff of experienced technical people is ready to serve you with installation of the unit provided necessary inputs of water connection, adequate water pressure etc is provided by the purchaser. WOIL will not be responsible if the purchaser does not fulfill the prerequisite of installation.

4. Any contrary claim regarding quality of water by domestic purchaser of water purifier shall only be tested/determined by WOIL's authorized personnel at its sole discretion.

5. The Warranty Period will not be extended or renewed or otherwise affected due to subsequent resale, repair or replacement of the product. However, repaired part(s) will be warranted for the remainder of the original Warranty period.

6. It is mandatory to provide the original bill/ invoice copy along with the duly stamped warranty card at the time of any repair work being done by authorized representatives of WOIL. If the customer fails to produce the necessary documentation then the repair work/assistance shall be provided on a chargeable basis.

7. WOIL accepts no responsibility for damage to the product due to usage of any ancillary equipment which is not authenticated/ recommended or advised by WOIL.

8. All installations shall be performed in accordance with the local, state and country electrical code. Appropriate regulatory authorities should be consulted where required.

9. In no event will WOIL be liable to the Purchaser for any incidental or consequential damages arising out of the use or inability to use the product or any claim by any other party. All claims are limited to the repair or the replacement of the defective part only and do not include any labour or transportation charges. The company is not liable for any delay in repairs/replacements due on account of any conditions beyond the control of the company or its representatives.

10. The courts at Delhi shall have exclusive jurisdiction on matters covered under this warranty.

11. It is entirely left to WOIL's discretion to effect repairs/replacements of parts at site of installation or any at service station of its branches or of its authorized representative/dealers.

12. While WOIL will make every effort to carry out repairs/replacement of parts under this warranty as soon as possible, it is expressly made clear that WOIL shall not be responsible to do so within any specified period of time.

13. In the event of any unforeseen circumstance, and spares not being available the WOIL's prevailing depreciation rules will be binding on the purchaser to accept as a commercial solution in lieu of repairs.

# Installation Report

## Whirlpool of India Limited – Whirlpool Service

### Minerala 90 Platinum

Serial No. \_\_\_\_\_ Model No. \_\_\_\_\_

Magicare Customer ID no. \_\_\_\_\_

Tel. No. \_\_\_\_\_

Address \_\_\_\_\_

#### Installation Check Points

Machine Delivered on \_\_\_\_\_ Machine Installed on \_\_\_\_\_

Tick Appropriate (By Service Engineer)		
1. Any transit damage observed	<input type="checkbox"/> Yes	<input type="checkbox"/> No
2. If poor earthing, customer has been advised	<input type="checkbox"/> Yes	<input type="checkbox"/> No
3. User manual delivered	<input type="checkbox"/> Yes	<input type="checkbox"/> No
4. Demonstrate/explain basic maintenance	<input type="checkbox"/> Yes	<input type="checkbox"/> No
5. Warranty term explained	<input type="checkbox"/> Yes	<input type="checkbox"/> No
6. Basic function explained	<input type="checkbox"/> Yes	<input type="checkbox"/> No
7. Do's & Don'ts explained	<input type="checkbox"/> Yes	<input type="checkbox"/> No

Installed by: \_\_\_\_\_

Signature: \_\_\_\_\_

#### Customer's Response:

1. The Installation person was courteous & helpful. Yes ☐ No ☐
2. I would describe my experience with installation. Unacceptable ☐ Satisfactory ☐
- Not satisfactory ☐ Very satisfactory ☐

I certify that the above information & check have been done to my satisfaction & I am fully satisfied with the installation of the RO System product.

Customer's signature: \_\_\_\_\_ Date: \_\_\_\_\_ Time: \_\_\_\_\_

## Frequently Asked Questions

### Q.1 How effective is Reverse Osmosis filtration compared to other methods ?

Reverse osmosis, also known as hyperfiltration, is one of the finest means of filtration available today. It is the highly convenient convenient and effective method of water filtration.

Reverse osmosis refers to the process of forcing water through a semi-permeable membrane under pressure, which is rated at 0.0001 micron (equals to 0.00000004 inch!). This is the technology used to make bottled water.

Non-RO water filters are much less effective, and the pore size on these filter media are much bigger. They can filter out coarse particles, sediments and elements only up to their micron rating. Anything finer and most dissolved substances cannot be filtered out. As a result, water is far less cleaner and safer compared to reverse osmosis filtration.

### Q.2 How does Reverse Osmosis work?

Reverse osmosis uses a membrane that is semi-permeable, allowing water to pass through it, while rejecting the contaminants that are too large to pass through the tiny pores in the membrane.

Reverse Osmosis, or RO for short, is the opposite of the natural process by which moisture is taken up by living cells. Root cells of plants, for example, have special cell walls that allow water to pass through them. In reverse osmosis, water is forced against a membrane that is semi-permeable, allowing water to pass through it, while rejecting the contaminants that are too large to pass through the tiny pores in the membrane. Impurities are left behind and are rinsed away to a waste drain.

### Q.3 What does TDS (Total Dissolved Solids) mean?

Water which begins its natural cycle as rain, comes into contact with many sources of contamination before eventually finding its way to your tap. The various minerals (including heavy metal ions) and salts that have been dissolved by the water during this cycle are called Total Dissolved Solids (TDS). TDS meter measures the PPM (parts per million) value of inorganic dissolved substances in the water.

## Whirlpool Service

You may call us at:-



Or email us on:-

[helpdeskindia@whirlpool.com](mailto:helpdeskindia@whirlpool.com)

Or write to us:-

Head - Corporate Consumer Cell  
Whirlpool of India Ltd.  
# 28, N.I.T.  
Faridabad – 121 001 (Haryana)  
India  
91(129) 6451019 / 6451030  
[www.whirlpoolindia.com](http://www.whirlpoolindia.com)

Technical Specifications

Specifications	Minerala 90 Platinum
Reservoir Tank Capacity	8.5 Litres
Filtration Capacity	13.5 LPH @ 25°C, 20 psi
Dimensions (H x D x W)	412mm x 276mm x 534mm
Weight	10.0 kg
Power Consumption	36W Max.
Rated Voltage	230V 50 Hz
Operating Voltage Range	160V - 260V
Current	1.5A
Min/Max Tap Water Pressure	4 psi / 60 psi
Filter Cartridges	Pre-Filter, Sediment Filter, Pre-Carbon Filter, RO Membrane, Post-Carbon + MES Filter
% Recovery	25%*
% Reduction in TDS	93%*



 **WARNING**

**Electric Shock Hazard**

- Disconnect power before servicing.
- Do not reconnect electrical supply without terminal power in place.
- Failure to do so can result in death or electrical shock.

Note: In line with Whirlpool of India's policy of continuous improvements specifications are subject to change without prior notice

\* Permeate flow and salt rejection based on the following test conditions:  
750 ppm tap water, 25°C, 25% recovery and with feed pressure of 20 psi.

Suitable for TDS of Input water 500 ~ 2500 PPM

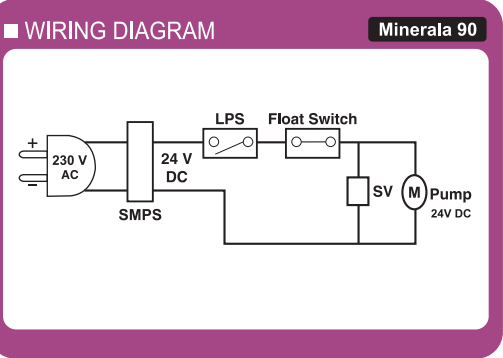

Water Purifier(RO) Disposal



By ensuring this product is disposed of correctly ,you will help avoid potential negative consequences for the environment and human health, which could otherwise be caused by inappropriate waste handling of this product.

The Symbol on the product or on the documents accompanying the product , indicates that this appliance may not be treated as household waste. Instead it shall be handed over to the authorized collection center for the recycling of electrical and electronic equipment waste generated at the end of life of the product. Disposal must be carried out in accordance with local environmental regulations for e-waste disposal ,which mandate channelization of e-waste to authorized collection center's) or registered dismantler(s) or recycler(s) or returned to the pick-up or take back services provided by the manufacturer.

For more detailed information about treatment, recovery , disposal and recycling of this product ,please call @ 60008558\* ( for private subscribers ) & 18601804558 ( for BSNL & MTNL subscribers ) or please visit [www.whirlpoolindia.com](http://www.whirlpoolindia.com)

\* Prefix your city STD code