

KENT Force
Cyclonic Vacuum Cleaner
KSL-160



Instruction Manual



CYCLONE5 Technology
Cleans with lower dust discharge
using HEPA filter

New Age
Pure Cleaning
Healthy Living

Welcome to KENT

Dear Customer,

At the outset, allow us to thank you for your trust in KENT Force Cyclonic Vacuum Cleaner. At KENT, we take pride in our reputation for product quality and industry proven performance. We are certain that your decision to own KENT Force Cyclonic Vacuum Cleaner will go a long way towards keeping you and your family in good health. We are confident that you will be more than satisfied with its performance and that it will serve your need for safer and cleaner living without any compromise.

This guide will help you in getting the best out of your KENT Force Cyclonic Vacuum Cleaner. Please go through the booklet to familiarise yourself with operation and maintenance.

You can look forward to years of trouble-free service. To ensure that the warranty of your KENT Force Cyclonic Vacuum Cleaner is effective, it is important that you fill up the enclosed warranty card and mail it to us within 15 days of purchase.

In case you require any further information, please contact your nearest KENT dealer/branch.

Happy Cleaning,

KENT RO Systems LTD.



1. Introduction	1
2. Features: KENT Force Cyclonic Vacuum Cleaner.....	1
3. Know Your Product	1
4. Items in the Box.....	2
5. Assembling: KENT Force Cyclonic Vacuum Cleaner.....	2
6. Using the Appliance.....	3
7. Important Instructions	4
8. Cleaning and Maintenance	5
9. Important Safety Instructions	6
10. Troubleshooting.....	7
11. Technical Specifications	8

Introduction

We, at KENT have always believed that a clean and healthy life is a right of every individual. This ethos is what made us embark on a journey to develop innovative solutions for cleaning water, vegetables and air. With the use of innovative technology and the support of a competent service network, we have been able to create a brand that has become synonymous with well-being and health.

Continuing with the tradition, we now present the KENT Force Cyclonic Vacuum Cleaner, with futuristic and state-of-the-art Cyclonic technology and HEPA filters to provide clean, dust-free and spotless surroundings.

KENT Force Cyclonic Vacuum Cleaner does not use filtration bags, as found in traditional vacuum cleaners available in the market. Instead, air and dust are sucked at high speed creating a fast-spinning vortex and the dust is separated in a detachable cylindrical collection vessel or bin. The Cyclonic technology and HEPA filter in KENT Force Cyclonic Vacuum Cleaner also reduce air pollution with lower dust discharge.

Features: KENT Force Cyclonic Vacuum Cleaner

1. Advanced Force Technology (without filtration bags) for dust collection and HEPA (High Efficiency Particulate Arrestor) based discharge filter.

2. High efficiency motor with strong suction force for efficient cleaning.

3. High efficiency HEPA filter.

4. Reduces air pollution due to lower dust and particulate matter (PM) discharge.
5. Auto power cord retractor.

6. Rubberised wheels.

7. Low noise.

8. Dust container full indicator.

9. Compact and contemporary design.

Know Your Product

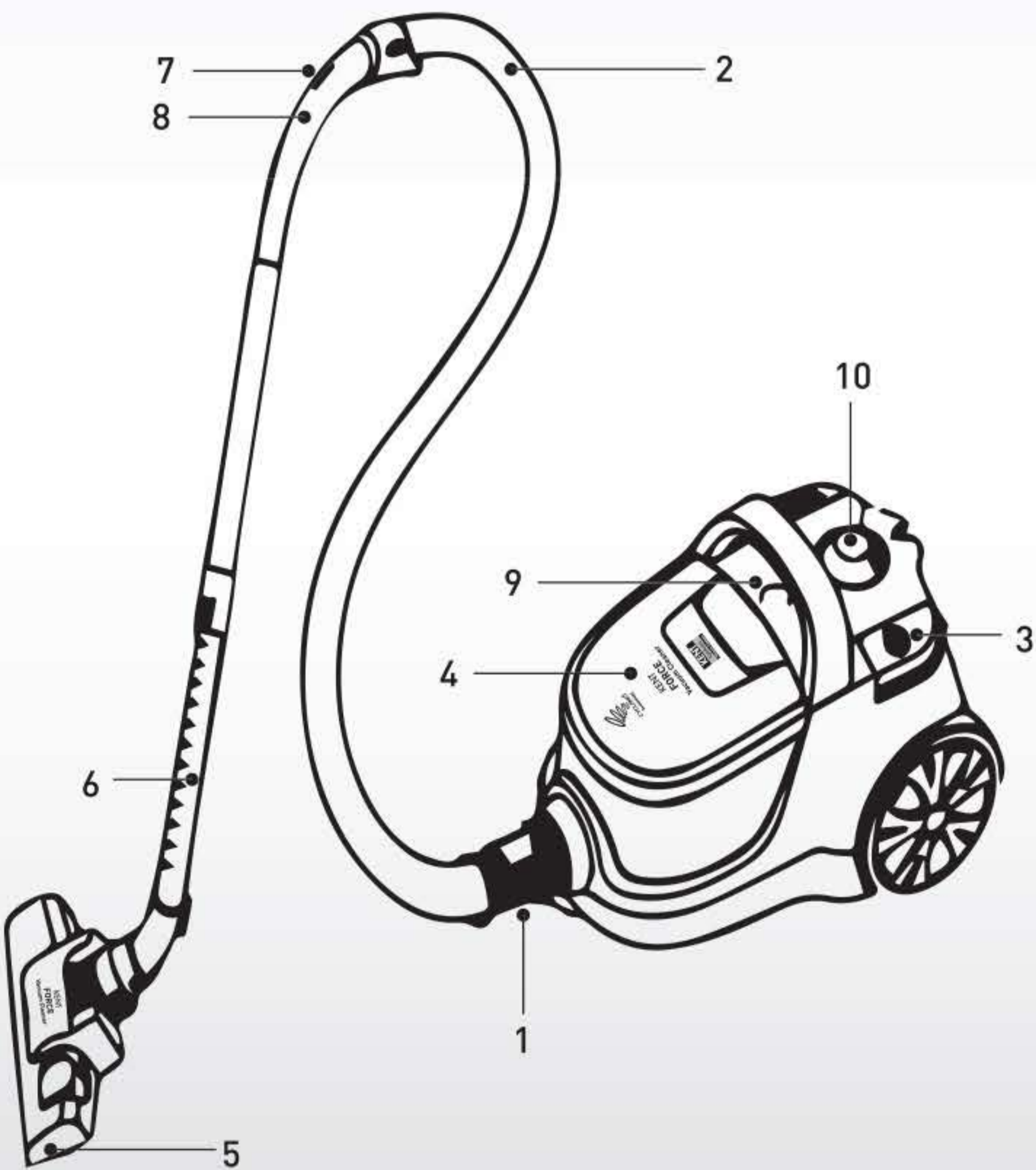

1. Flexible Hose Pipe

2. Hose

3. On/Off Button

4. Front Cover

5. Floor Brush

6. Metal Telescopic Tube

7. Suction Control

8. Handle

9. Indicator

10. Speed Controller

Items in the Box

- 1. KENT Force Cyclonic Vacuum Cleaner : 01 No.
- 2. Flexible Hose : 01 No.
- 3. Metal Telescopic Tube : 01 No.
- 4. Crevice tool : 01 No.
- 5. Dust Brush : 01 No.
- 6. Floor/Carpet Brush : 01 No.
- 7. User Guide : 01 No.

Assembling: KENT Force Cyclonic Vacuum Cleaner

- 1. Unpack the unit completely and remove any stickers that can prevent unit operation.
- 2. Check the unit for damages. Do not use in case of damage.
- 3. Before switching the unit on, make sure that your home’s main voltage corresponds to the unit operating voltage.

Attaching/Detaching Dust Container to Vacuum Cleaner’s Body

a. Attaching

- 1. To place the dust container to the body, gently place it in the direction of the arrow.
- 2. Ensure that the dust container is properly placed, otherwise it would lead to damaging the filters and also nonfunctioning of vacuum cleaner.

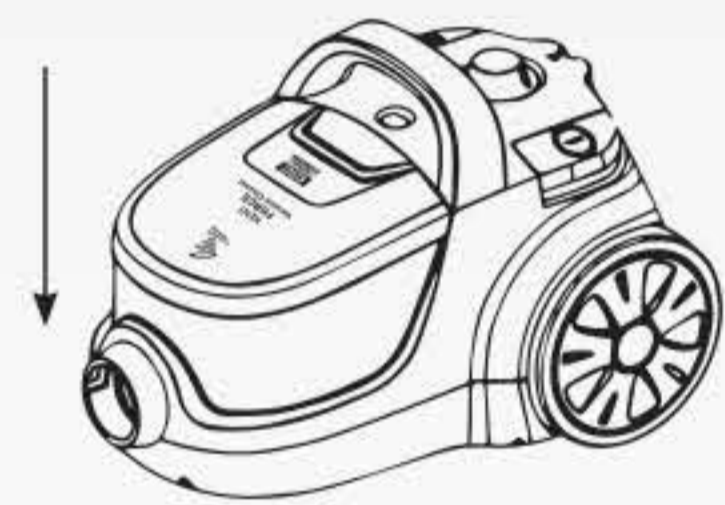

b. Detaching

Press the dust container removal button to remove the dust container and pull the container holding the dust container carrying handle as shown in the figure.

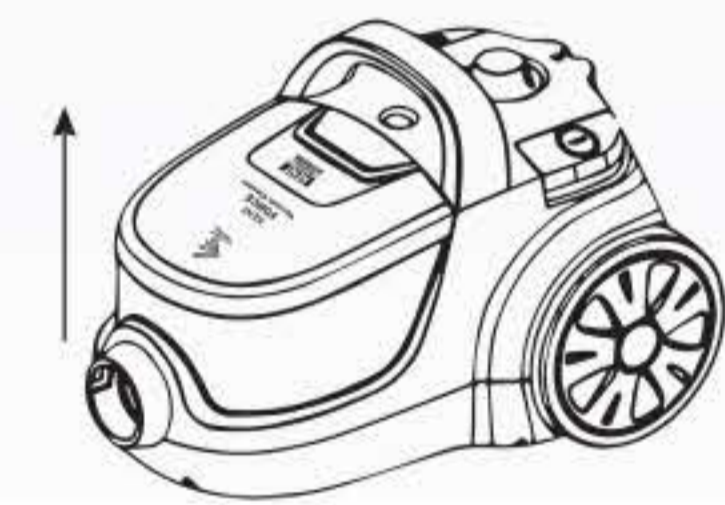

Attaching/Detaching the Flexible Hose

a. Attaching

- 1. To attach the flexible hose, pull the hose cap in the direction of the arrow until it is aligned with the housing.
- 2. The grooves on the flexible hose cap must be aligned properly.

b. Detaching

To detach the flexible hose, press the tabs on the hose cap and pull it.



Attaching/Detaching Metal Telescopic Tube

a. Attaching

Attach the telescopic tube to the handle and pull the telescopic tube from the handle.

b. Detaching

To detach the telescopic tube, push the telescopic tube adjustment latch and pull the telescopic tube to adjust its length.

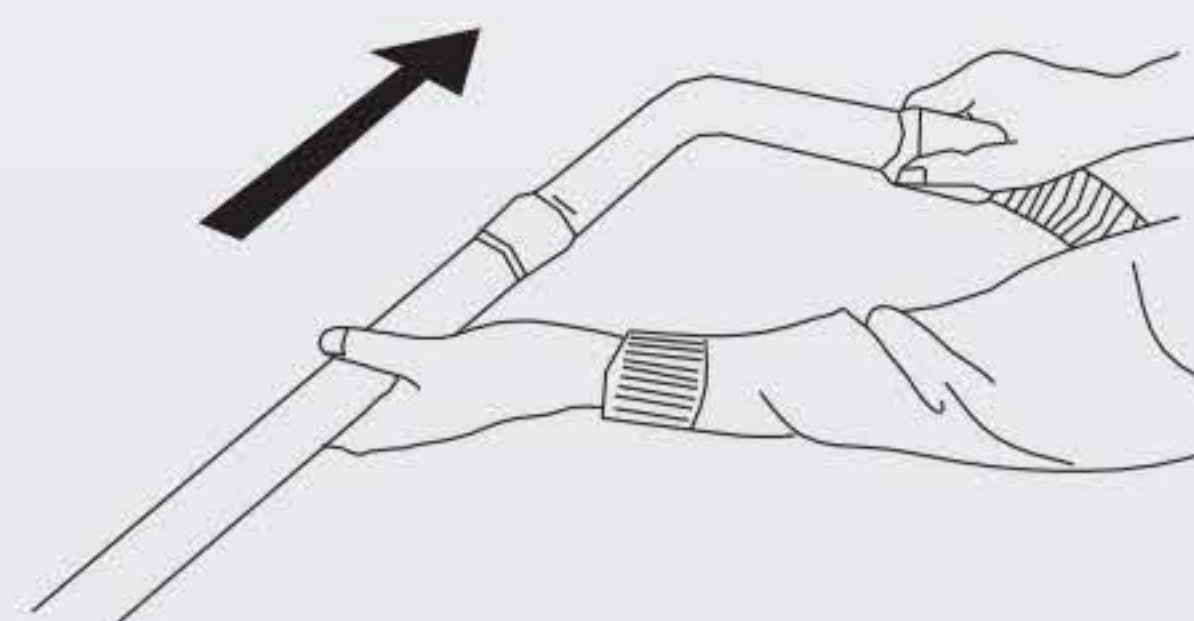

Attaching/Detaching Floor/Carpet Brush

a. Attaching

Attach the carpet brush to the telescopic tube in the direction of the arrow.

b. Detaching

You can detach the telescopic tube from the carpet brush by pulling it.

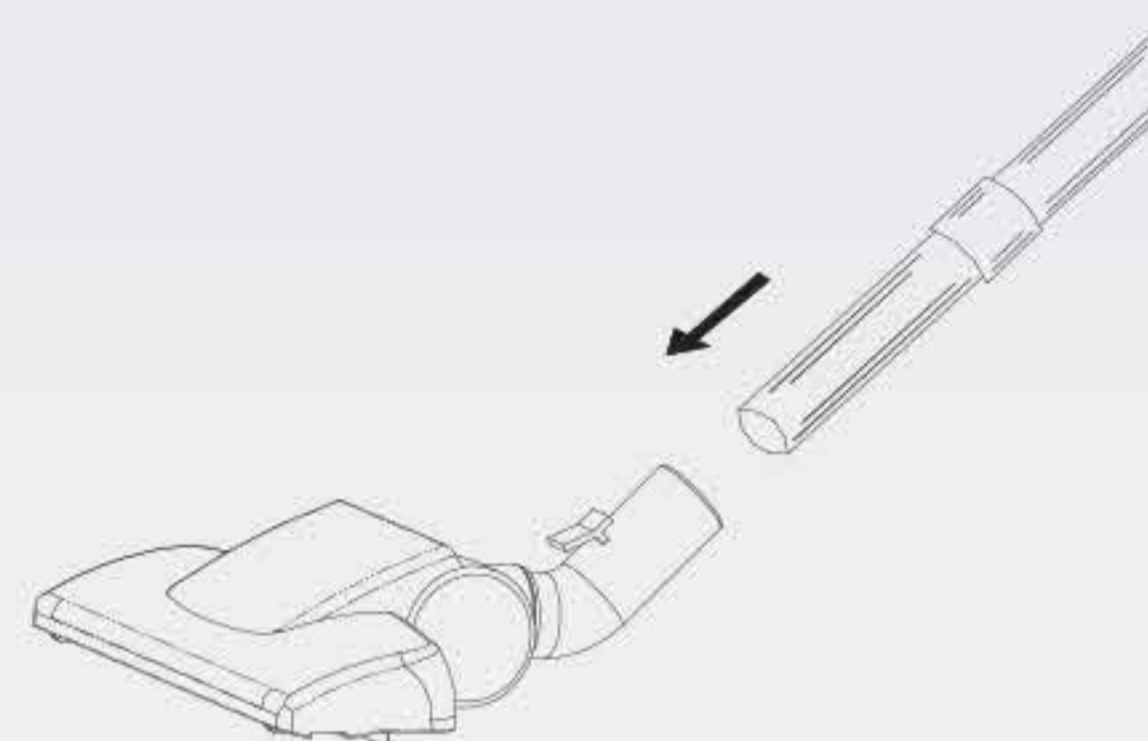

Adjustment in the Floor/Carpet Brush

Adjust the settings by pressing the adjustment latch located on the carpet brush;

- To use brush on hard floor, extend the brush.
- For use on carpets or rugs, retract the brush.

Note: Always remove the plug from the power socket before fitting or removing accessories.

Using the Appliance

- To use the appliance, pull out the power cord located at the back and plug it.

Warning: The power cord comes with a yellow strip. While pulling out the power cord, ensure that the cable is pulled slowly and till the yellow mark only. Do not pull the cord beyond red mark.

- Press the on/off button to switch on your appliance.
- To rewind the power cable post use, press the rewind button with one hand and guide the cable with the other hand to ensure that it does not whip, causing damage.

Adjusting Suction Power

You can adjust the suction power of the appliance by turning the suction power button located on the body. Use different settings according to the type of the surface to be cleaned.

- To increase the suction power, rotate the button clockwise.
- To decrease the suction power, rotate the button anti-clockwise.

Note: Always remove the plug from the power socket before fitting or removing accessories.

Use of Accessories

a. Crevice Tool

Ideal for the cleaning of surfaces that are difficult to clean otherwise such as radiators, couch corners, under the couch and in between cushions.

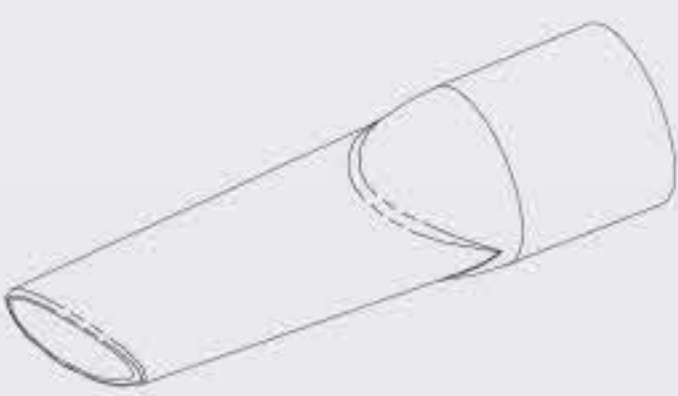

b. Dust Brush

Ideal for daily cleaning of carpets and hard floors.



c. Floor/Carpet Brush

Ideal for the daily cleaning of carpets and hard/wooden floors.

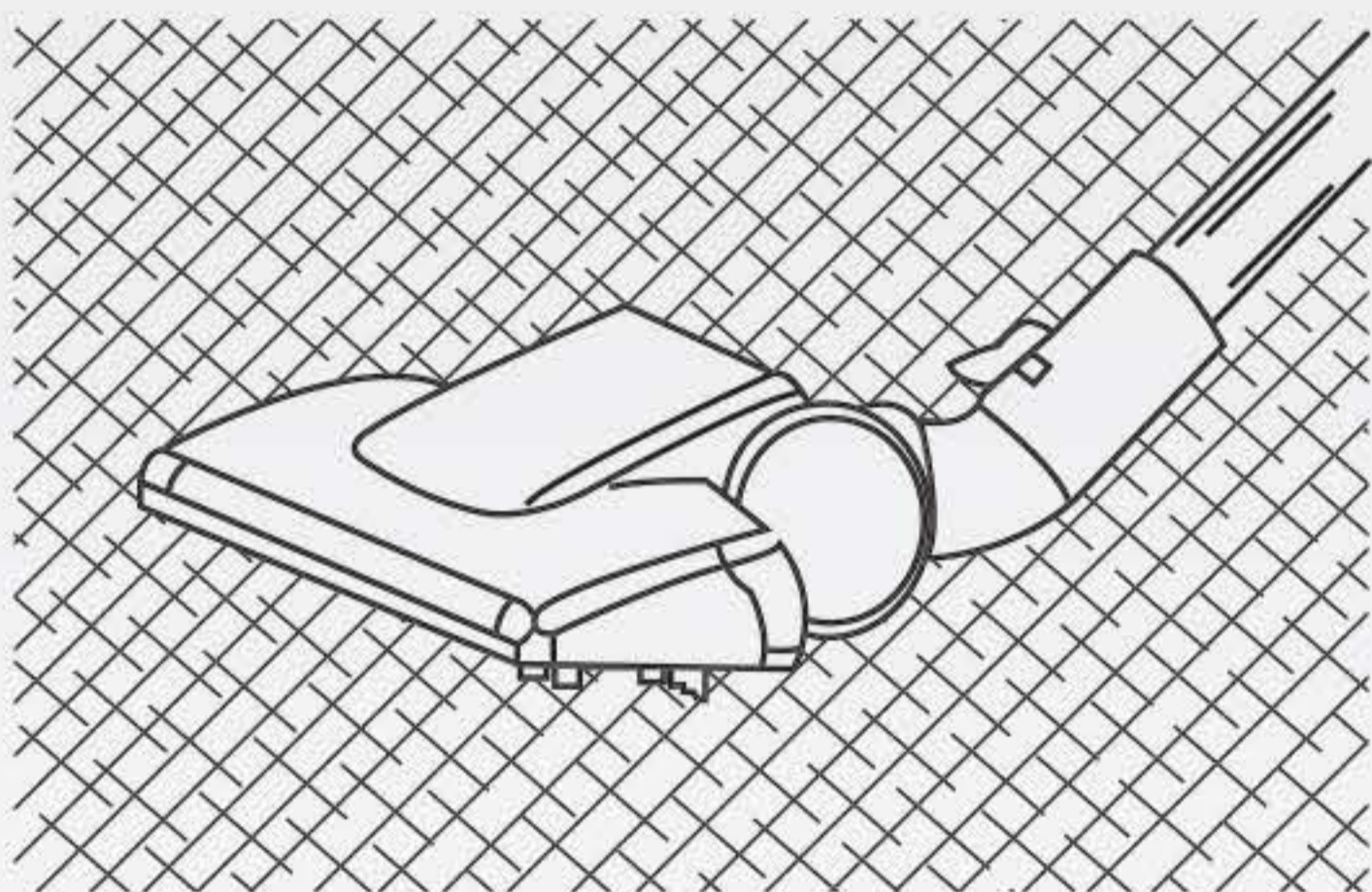

Carpet

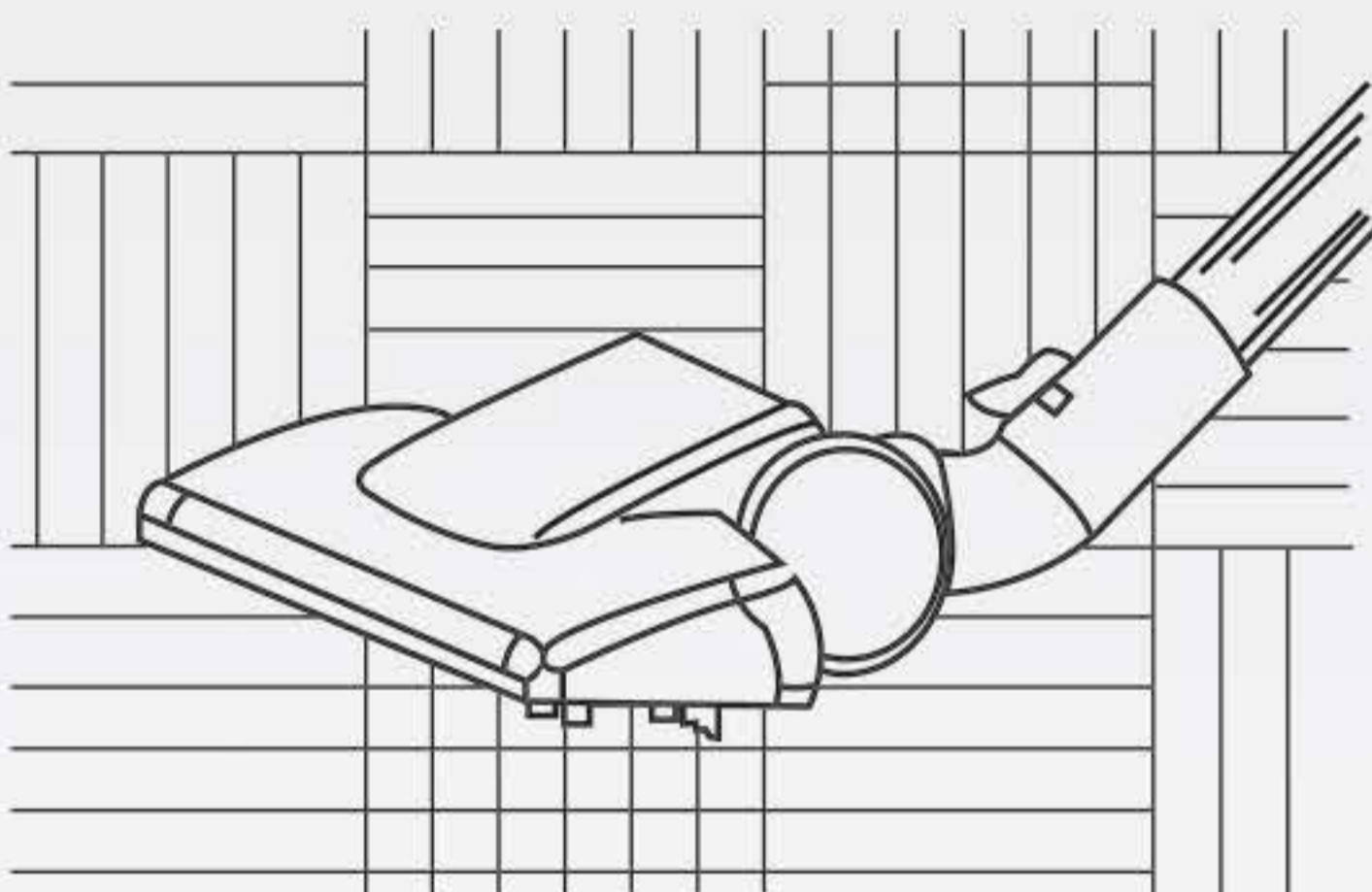

Hard Floor

Important Instructions

- 1. Do not operate the vacuum cleaner too close to heaters, radiators, cigarette butts, etc.
- 2. Do not plug or unplug the device with wet hands.
- 3. Before using the vacuum cleaner, remove large or sharp objects from the floor in order to prevent damage of HEPA filter.
- 4. To unplug, do not pull electrical cord. Pull out the plug.

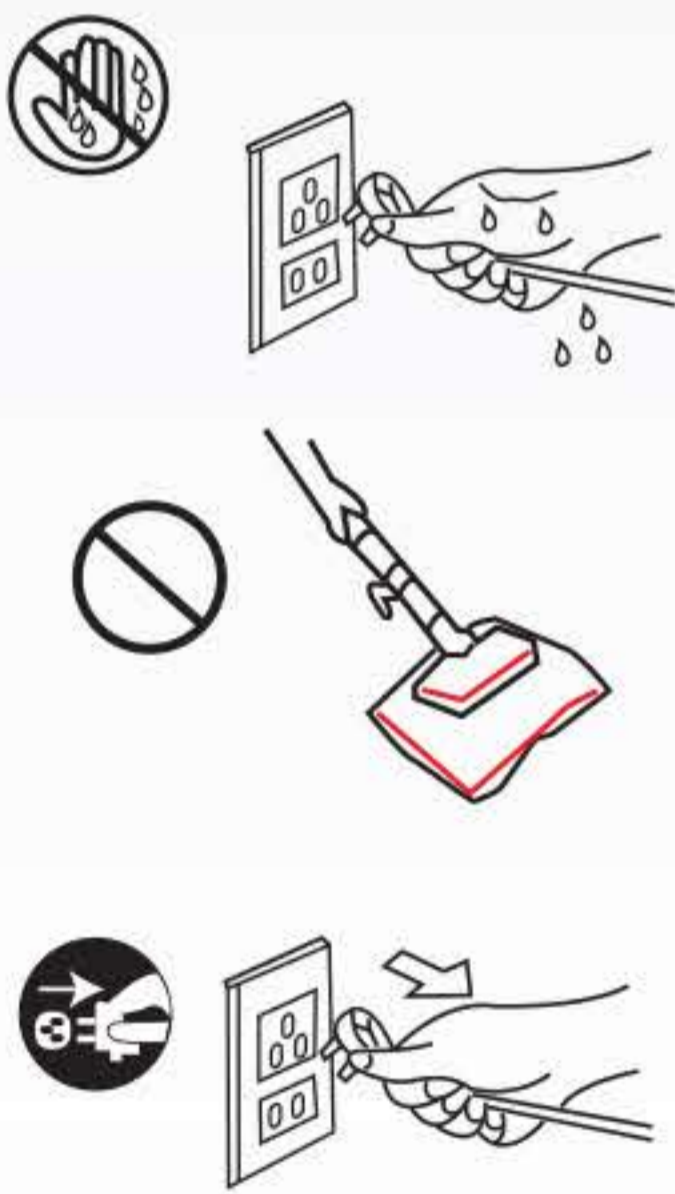

Note: If the suction pipe or metal telescopic tube is blocked, switch off vacuum cleaner at once. Unplug the appliance before clearing the blockage. Once done, you can start the vacuum cleaner again.

Cleaning and Maintenance

Switch off and unplug the appliance before cleaning it.

Note: Never use gasoline, solvent, abrasive cleaning agents, metal objects or hard brushes to clean the appliance.

a. Emptying the Dust Container

For your convenience, KENT Force Cyclonic Vacuum Cleaner comes with an indicator that flashes whenever the dust container fills up completely.

1. Press the dust container removal button and pull the container in the direction of the arrow.
2. Remove the filter assembly as shown in the image.
3. Remove the air outlet filter and empty the dust collected.
4. Re-assemble the container and filters in a reverse fashion.

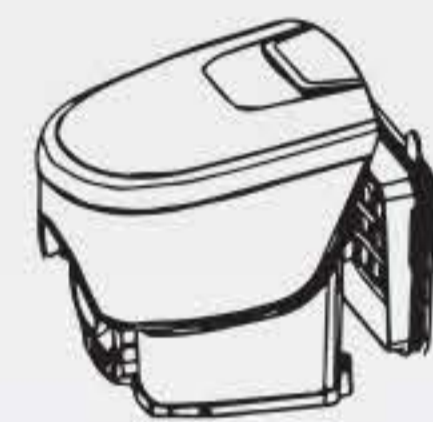
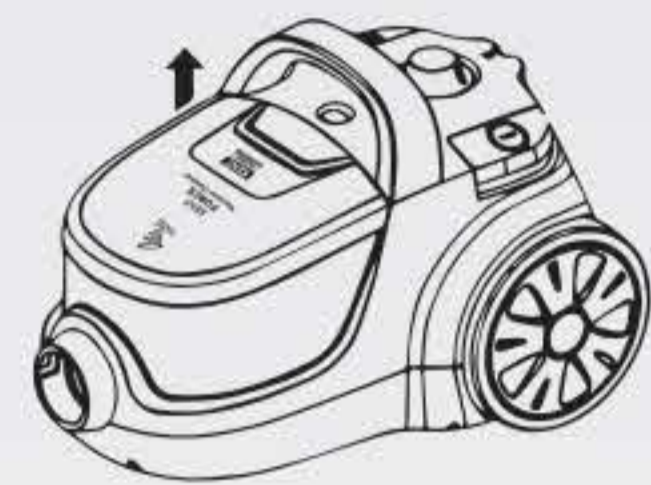

b. Washing and Cleaning of Filters.

KENT Force Cyclonic Vacuum Cleaner comes with two types of filters.

1. Foam Filter
2. HEPA Filter

For trouble free operations, it is important to clean the filters regularly.

Step 1: Remove the HEPA and Foam filters one by one as the foam filter is placed behind the HEPA filter.

Step 2: Clean and wash the filter under running water.

Step 3: After washing the foam filter, gently wring it and leave it to dry. The HEPA filter is not to be dried-wire hung.

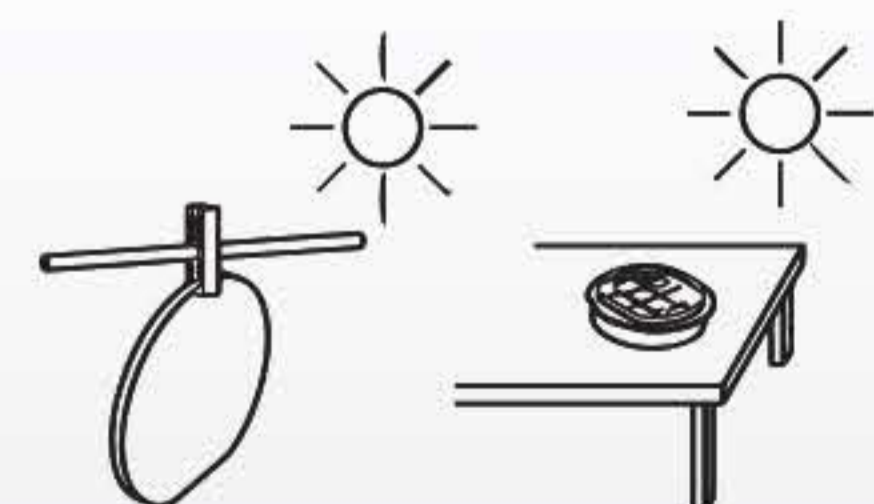

Storage

1. If you do not intend to use the appliance for a long time, store it carefully.
2. Unplug the appliance.
3. Keep the appliance out of the reach of children.

Important Safety Instructions

When using an electrical appliance, basic precaution should always be followed, including the following:

1. Do not leave the vacuum cleaner on when plugged in. Always unplug when not in use and before servicing.
2. To reduce the risk of electric shock, do not use on wet surfaces.
3. Use the appliance only as described in the manual.
4. Always use manufacture recommended attachments only.
5. Do not use the appliance if the cord or plug is damaged or worn out. Replace the damaged cord or plug immediately.
6. Do not try to service the appliance on your own. Send it to an authorised service center.
7. Never use cord as a handle, close door on cord, or pull cord around sharp edges or corners. Keep the cord away from heated surfaces.
8. Do not unplug the appliance by pulling the cord. Always unplug by pulling the plug and not the cord.
9. To avoid electric shocks, do not use the appliance with wet hands.
10. Keep hair, loose clothing, fingers and all parts of body away from moving parts.
11. Turn all controls off before unplugging.
12. Use extra precautions while cleaning stairs.
13. Do not use the appliance to pick any flammable or combustible liquids, such as gasoline. Do not use in areas where they may be present.
14. Hold the plug when rewinding onto cord reel. Do not allow the plug to whip when rewinding.
15. Unplug before connecting the hose.
16. Do not pick up anything that is burning or leaving smoke, such as cigarettes, matches or hot ashes.
17. Never use the appliance without the filter in place.
18. If the supply cord is damaged, it must be replaced by the manufacturer, its service agent or a similarly qualified person in order to avoid a hazard.
19. This appliance is suitable for indoor use only.
20. Keep away from children.

Troubleshooting

Problem	Possible Cause	Possible Solutions
The appliance does not switch on	1. Power Cord not firmly plugged into socket. 2. No power in the main supply.	1. Plug in the unit firmly. 2. Check the fuse or cutout switch. Replace the fuse or reset the switch. 3. Call an authorised service center.
The appliance has weak suction power	1. Filters are blocked.	1. Switch off the cleaner and disconnect the cleaner from the main power supply. 2. Remove the filters and clean them.
The hose or brush does not pickup any dust	1. Hose chocked or some blockage on brush.	1. Switch off the cleaner and disconnect the cleaner from the main power supply. 2. Remove the hose and/or brush and remove any blockage.

Technical Specifications

Model Name	KENT Force Cyclonic Vacuum Cleaner
Model Number	KSL-160
Net Weight	5.1 kg
Input Power Supply	Single Phase 220 V, AC 50 Hz 
Max. Vacuum Pressure	>24kpa
Noise	<79dB (A)
Airflow	>1.8m³/min.
Maximum Power	2000 W



July, 2017



KENT RO SYSTEMS LTD.

4-B, Toy City, Ecotech III, Greater Noida (W). U.P.-201306.

Ph.: +91-120-2397711

E-mail: sales@kent.co.in | website: www.kent.co.in.

For customer complaints, contact our Customer Care Officer at:

E-6, 7 & 8, Sector-59, Noida, U.P.-201 309, India. Call: 092-789-12345

E-mail: service@kent.co.in or visit us at www.kent.co.in

Made in China | Imported & Marketed by: KENT RO SYSTEMS LTD.