



OWNER'S MANUAL

WASHING MACHINE



Before beginning installation, read these instructions carefully. This will simplify installation and ensure that the product is installed correctly and safely. Leave these instructions near the product after installation for future reference.

EN ENGLISH

FHM1006#DW/L/S

FHM1065#DW/L/S

FHM1207#DW/L/S

#: Z / Y / X / A



MFL71716206
Rev.00_190620

www.lg.com

Copyright © 2020 LG Electronics Inc. All Rights Reserved.

Product Features



- **Protection against creases**
With the alternate rotation of the drum, creasing in the laundry is minimized.



- **Built-in heater**
Internal heater automatically heats the water to the best temperature on selected cycles.



- **More economical by Intelligent Wash System**
Intelligent Wash System detects the amount of load and water temperature, and then determines the optimum water level and washing time to minimize energy and water consumption.



- **Child Lock**
The Child lock prevents children from changing the settings, if they press any button during operation.



- **Low noise speed control system**
By sensing the amount of load and balance, it evenly distributes load to minimize the spinning noise level.



- **Auto Restart**
Auto Restart allows the program to restart all by itself in case of power failure. It does from the stage where it stopped.



- **6 Motion**
Washer is able to perform various drum actions or a combination of different actions depending on the wash program selected. Combined with a controlled spin speed and the ability of the drum to rotate both left and right, the wash performance of the machine is greatly improved, giving you perfect results every time.



- **Direct Drive System**
The advanced Brushless DC motor directly drives the drum without belt and pulley.

Contents

Safety Information.....	3
Specifications.....	4
Installation.....	5
Care before washing.....	11
Adding detergent.....	12
Function.....	14
How to use washer.....	15
Maintenance.....	22
Troubleshooting guide.....	26
Terms of Warranty.....	30

Safety Information

READ ALL INSTRUCTIONS AND EXPLANATION OF THE INSTALLATION BEFORE USE

- ⚠ WARNING** For your safety, the information in this manual must be followed to minimize the risk of fire or explosion, electric shock, or to prevent property damage, personal injury, or loss of life.

⚠ WARNING

IMPORTANT SAFETY INSTRUCTIONS

To reduce the risk of fire, electric shock, or injury to persons when using the washer, follow basic precautions, including the following:

- **Before installation, check exterior damages. If it has, do not install.**
- **Do not install or store the washer where it will be exposed to the weather (Rain / Water Splash).**
If the product is exposed to such conditions, electric shock, fire, break down or deformation may occur.
- **Do not tamper with controls.**
It may lead to electric shock, fire, break down or deformation.
- **Do not repair or replace any part of the washer or attempt any servicing unless specifically recommended in the user-maintenance instructions or published user-repair instructions that you understand and have the skills to carry out.**
Operating the machine with improperly replaced parts may be a cause for fire or electric shock.
- **Keep the area underneath and around your appliances free of combustible materials such as lint, paper, rags, chemicals, etc.**
Operating with such materials around the machine may trigger explosion or fire.
- **Close supervision is necessary if this appliance is used by or near children. Do not allow children to play on, with, or inside this or any other appliance.**
There is a potential danger that children might drown in the tub.
- **Keep small animals away from the appliance.**
- **Do not leave the washer door open. An open door could entice children to hang on the door or crawl inside the washer.**
- **Never reach into washer while it is moving. Wait until the drum has completely stopped.**
Even slow rotation can cause injury.
- **The laundry process can reduce the flame retardant of fabrics. To avoid such a result, carefully follow the garment manufacturer's wash and care instructions.**
- **Do not wash or dry articles that have been cleaned in, washed in, soaked in, or spotted with combustible or explosive substances (such as wax, oil, paint, gasoline, degreasers, dry-cleaning solvents, kerosene, etc.).**
It may ignite or explode. Oil may remain in the tub after a whole cycle resulting in fire during drying.
So, do not load oiled clothes.
- **Do not slam the washer door closed or try to force the door open when locked.**
This could result in damage to the washer.
- **When the machine runs high temperature, the front door may be very hot. Don't touch it.**
- **To minimize the possibility of electric shock, unplug this appliance from the power supply or disconnect the washer from the household distribution panel by removing the fuse or switching off the circuit breaker before attempting any maintenance or cleaning.**
- **When unplugging power cord, do not pull out by grasping the cord.**
Otherwise, the power cord may be damaged.
- **Never attempt to operate this appliance if it is damaged, malfunctioning, partially disassembled, or has missing or broken parts, including a damaged cord or plug.**
Operating with a damaged plug may cause electric shock.
- **Before discarding an old machine unplug it. Render the plug useless. Cut off the cable directly behind the appliance to prevent misuse.**
- **When a product was under water, Please call service center. The risk of electric shock and fire.**
- **When washer door is opened, do not push down the door excessively.**
This could topple over the washer.

GROUNDING INSTRUCTIONS

SAVE THESE INSTRUCTIONS

This appliance must be grounded. In the event of malfunction or breakdown, grounding will reduce the risk of electric shock by providing a path of least resistance for electric current. This appliance is equipped with cord having an equipment-grounding conductor and grounding plug. The plug must be plugged into an appropriate outlet that is properly installed and grounded in accordance with all local codes & ordinance.

- Do not use an adapter or otherwise defect the grounding plug.
- If you don't have the proper outlet, consult an electrician.

- ⚠ WARNING** Improper connection of the equipment-grounding conductor can result in risk of electric shock. Check with a qualified electrician or serviceman if you are in doubt the plug provided with the appliance-if it does not fit the outlet, have a proper outlet installed by a qualified electrician as to whether the appliance is properly grounded. Do not modify the plug provided with the appliance-if it does not fit the outlet, have a proper outlet installed by a qualified electrician.

S pecifications

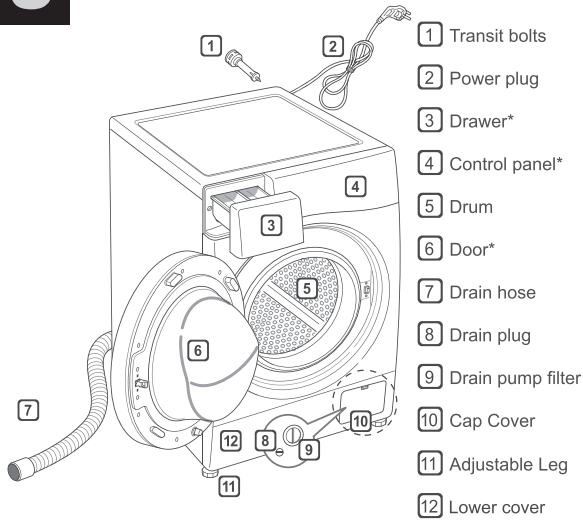

■ Product dimension(mm)

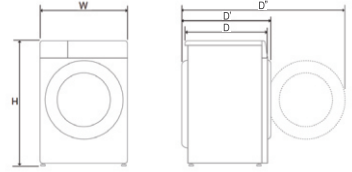

W	600mm	D	440mm	H	850mm
D'	490mm	D*	890mm		

■ Name : Front loading washing machine

■ Power supply : 230V~,50Hz

■ Weight/Max.Watt : 60kg / 1700W

■ Wash capacity : 6.0kg : [FHM1006#DW/L/S]
 6.5kg : [FHM1065#DW/L/S]
 7.0kg : [FHM1207#DW/L/S]

■ Spin speed : 0/400/800/900/1000 : [FHM1006#DW/L/S/FHM1065#DW/L/S]
 0/400/800/1000/1200 : [FHM1207#DW/L/S]

■ Permissible water pressure : 50-800kPa (0.5-8kgf/cm²)

- The appearance and specifications may be varied without notice to raise the product quality.

■ Accessories

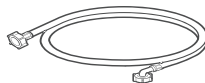

Inlet hose*(1EA)



Spanner(1EA)

* Part can be different according to different models.

Installation

Install or store where it will not be exposed to temperatures below freezing or exposed to the weather. Properly ground washer to conform with all governing codes and ordinances. The base opening must not be obstructed by carpeting when the washing machine is installed on a carpeted floor.

In countries where there are areas which may be subjected to infestation by cockroaches or other vermin, pay particular attention in keeping the appliance and its surroundings in clean condition at all times. Any damage which may be caused by cockroaches or other vermin will not be covered by the appliance guarantee.

Unpacking

- ☞ Cut the straps and open the upper flaps of Packing box & take out the Anti Rat Cover.
- ☞ While taking out the Machine from packing, please take due care in removing packing support given at centre of the base packing.

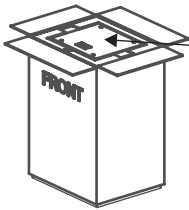

☞ Anti Rat Cover is placed below the upper flaps of the Packing box.

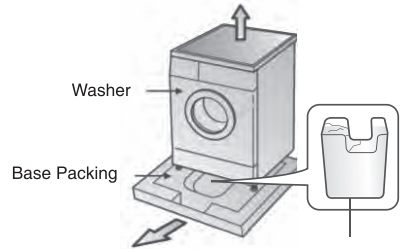

Anti Rat Cover installation



Screw → 

Washer → 

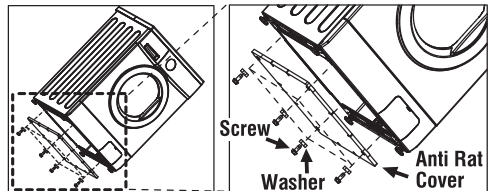

- ☞ Accessories for fixing Anti Rat Cover.

1. Take out the poly bag (containing Screws/Washers).
2. Tilt the machine sideways.
3. Bend & insert the flaps of Anti Rat Cover into the bottom side of machine.
4. Assemble the Anti Rat Cover on the bottom side of the machine by using Screws & Washers.

Transit bolts

The appliance is fitted with transit bolts to prevent internal damage during transport.

- Packing and all transit bolts must be removed before using the Machine.

I nstallation

■ Removing transit bolts

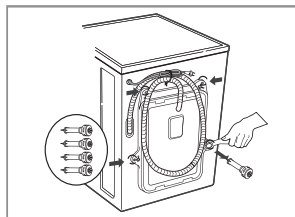
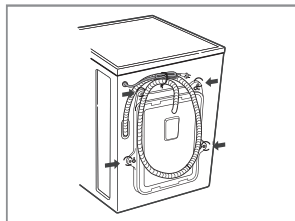

1. To prevent internal damage during transport, the special 4 bolts are locked. Before operating the washer, remove the bolts along with the rubber bungs.
 - If they are not removed, it may cause heavy vibration, noise and malfunction.
2. Unscrew the 4 bolts with the spanner supplied.
3. Take out the 4 bolts along with the rubber bungs by slightly twisting the bung. Keep the 4 bolts and the spanner for future use.
 - Whenever the appliance is transported, the transit bolts must be refitted.
4. Close the holes with the caps supplied.

■ Installation place requirement

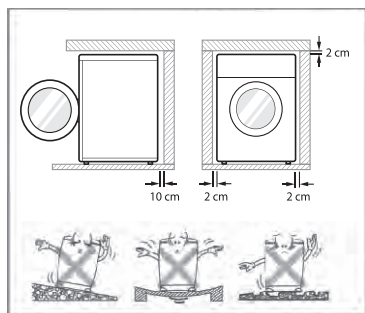

Level floor :

Allowable slope under entire washer is 1°

Power outlet :

Must be within 1 meter of either side of location of washer. Do not overload the outlet with more than one appliance.

Additional Clearance :

For wall, door and floor modeling is required.

(10cm : rear /2cm:right & left side)

Do not place or store laundry products on top of washer at any times.

They can damage the finish or controls.

■ Positioning

- Install the washer on a flat hard floor.
- Make sure that air circulation around the washer is not impeded by carpets, rug etc.
- Never try to correct any unevenness in the floor with pieces of wood, cardboard or similar materials under the washer.
- If it is impossible to avoid positioning the washer next to a gas cooker or coal burning stove, an insulating(85x60cm) covered with aluminum foil on the side facing the cooker or stove, must be inserted between the two appliances.
- Do not install the appliance in rooms where freezing temperatures may occur. Frozen hoses may burst under pressure. The reliability of the electronic control unit may be impaired at temperatures below freezing point.
- Please ensure that when the washer is installed, it is easily accessible for the engineer in the event of a breakdown.
- With the washer installed adjust all four adjustable legs using the transit bolt spanner provided ensuring the appliance is stable, and a clearance of approximately 20mm is left between the top of the washer and the underside of the work-top.

⚠ WARNING

It is advisable to avoid, the usage of trolley & the movement of Washing Machine after installation. As it may disturb the levelling of washer, which can create excessive noise & vibration.

Installation

■ Electrical connection

1. Do not use an extension cord or double adapter.
 2. If the supply cord is damaged, it must be replaced by the manufacturer or its service agents or equally qualified person in order to avoid a hazard.
 3. Always unplug the machine and turn off the water supply after use.
 4. Connect the machine to an earthed socket in accordance with current wiring regulations.
 5. The appliance must be positioned so that the plug is easily accessible.
- Repairs to the washing machine must only be carried out by qualified personnel. Repairs carried out by inexperienced persons may cause injury or serious malfunctioning. Contact your local service center.
 - Do not install your washing machine in rooms where temperature below freezing may occur. Frozen hoses may burst under pressure. The reliability of the electronic control unit may be impaired at temperatures below freezing point.
 - If the appliance is delivered in the winter months and temperatures are below freezing: Place the washing machine at room temperature for a few hours before putting it into operation.

⚠ CAUTION

The appliance is not intended for use by young children or infirm persons without supervision. Young children should be supervised to ensure that they do not play with appliance.

⚠ CAUTION

CAUTION concerning the Power Cord

Most appliances recommend they be placed upon a dedicated circuit; that is, a single outlet circuit which powers only that appliance and has no additional outlets or branch circuits. Check the specification page of this owner's manual to be certain.

Do not overload wall outlets. Overloaded wall outlets, loose or damaged wall outlets, extension cords, frayed power cords, or damaged or cracked wire insulation are dangerous. Any of these conditions could result in electric shock or fire. Periodically examine the cord of your appliance, and if its appearance indicates damage or deterioration, unplug it, discontinue use of the appliance, and have the cord replaced with an exact replacement part by an authorized service Centre.

Protect the power cord from physical or mechanical abuse, such as being twisted, kinked, pinched, closed in a door, or walked upon. Pay particular attention to plugs, wall outlets, and the point where the cord exits the appliance.

■ Washing Machine is to be connected to the water mains using new hose-sets and old hose-sets should not be used.

■ Connecting water supply hose*

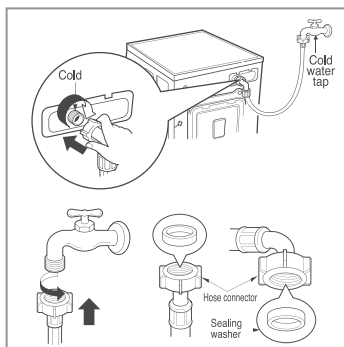

- ▶ Water supply pressure must be between 50kPa and 800kPa (0.5~8 kgf/cm²)
- ▶ Don't strip or crossthread when connecting Inlet hose to the valve.
- ▶ If the water supply pressure is more than 800kPa, a decompression device should be installed.
- Two rubber seals are supplied with the water inlet hoses. They are used for preventing water leaks.
- Make sure the connection to taps is tight enough.
- Periodically check the condition of the hose and replace the hose if necessary.
- Make sure that there is no kink on the hose and that it is not crushed.

NOTE After completing connection, if water leaks from the hose, repeat the same steps. Use the most conventional type of faucet for water supply. In case the faucet is square or too big, remove the spacing ring before inserting the faucet into the adaptor.

* Part can be different according to different models.

Installation

■ Normal Tap without thread & screw type inlet hose

1. Unscrew the fixing screw to attach the tap.

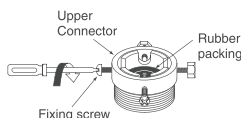

2. Push the connector up till the rubber packing is in tight contact with the tap. Then tighten the 4 screws.

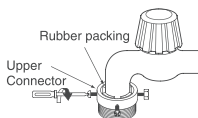

3. Push the water supply hose vertically upwards so that the rubber packing within the hose can adhere completely to the tap and then tighten it by screwing it to the right.

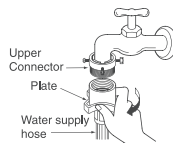

■ Normal Tap without thread & one touch type inlet hose (Single inlet models)

1. Untighten the upper connector screw.

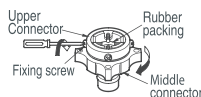

2. Push the upper connector up till the rubber packing is in tight contact with the tap. Then tighten the 4 screws.

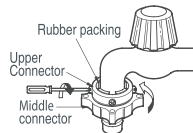

3. Connect the water supply hose to the middle connector, pushing the plate down.

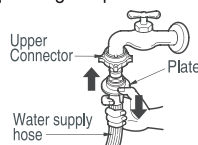

• In case the diameter of the tap is large remove the guide plate.

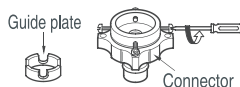

• Turn the middle connector not to have water leaked.

• Make sure that the rubber seal is inside the hose connector.

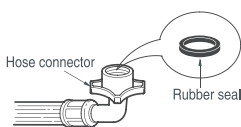

• To separate the water supply hose from the middle connector shut off the tap. Then pull the inlet hose down, pushing the plate down.

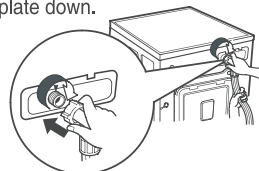

• Your machine comes with only cold water connection.
• Make sure that there are no kinks in the hose and that it is not crushed.

Use the horizontal tap

Horizontal tap



Extension tap



Square tap



■ Tap with thread & screw type inlet hose

1. • Two rubber seals are provided with inlet hose connectors.
• These are used to prevent water leakage.
• Make sure the connection to tap is sufficiently tight.

2. Check rubber seals in inlet hose connectors.

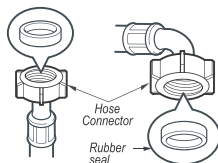

3. Screw the hose connector onto water supply tap.

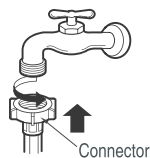

Installation

This appliance is not designed for maritime use or for use in mobile installations such as caravans, aircraft etc. This appliance is intended to be used in household only.

Turn off the stopcock if the machine is to be left for any length of time (e.g. holiday), especially if there is no floor drain (gully) in the immediate vicinity.

When disposing of the appliance, cut off the mains cable and destroy the plug. Break the door lock to prevent young children being trapped inside.

Packaging material (e.g. Films, Styrofoam, PE Bags) can be dangerous for children. There is a risk of suffocation!

Keep all packaging well away from children.

■ Installation of drain hose

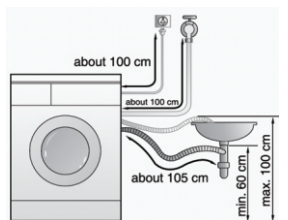

- The drain hose should not be placed higher than 100 cm above the floor.
- Proper securing of the drain hose will protect the floor from getting wet due to water leakage.
- When the drain hose is too long, do not force back into the washer. This will cause abnormal noise/leakage.

Installation

■ Level adjustment



1. Adjusting the washing machine level properly prevents excessive noise and vibration.
Install the appliance on a solid and level floor surface, preferably in a corner of the room.

NOTE Timber or suspended type flooring may contribute to excessive vibration and unbalance errors.

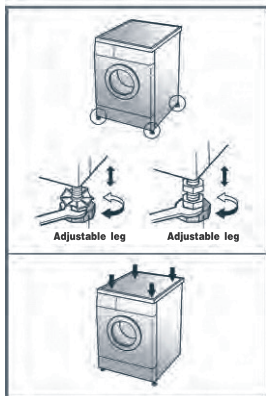

2. If the floor is uneven, adjust the adjustable leg as required. (do not insert pieces of wood etc. under the legs)
Make sure that all four legs are stable and resting on the floor and then check that the appliance is perfectly level. (use a spirit level)

※ *After the washer is levelled, tighten all lock nuts up towards the base of the washer.*

NOTE In the case the washing machine is installed on a raised platform, it must be securely fastened in order to eliminate the risk that it might fall off.

※ *Diagonal Check*

When pushing down the edges of the washing machine top plate diagonally, the machine should not move up and down at all. (Please, check both of two directions)

If machine rocks when pushing the machine top plate diagonally, adjust the legs again.

■ Concrete floors

- The installation surface must be clean, dry and level.
- Install washer on a flat hard floor.

■ Tile floors (Slippery floors)

- Position each leg on the Tread Mate and level the machine to suit. (Cut Tread Mate into 70x70 mm sections and stick the pieces on to the dry tile where machine is to be placed.)
- ※ *Tread Mate is a self adhesive material used on ladders & steps that prevents slipping.*

■ Wooden floors (Suspended floors)

- Wooden floors are particularly susceptible to vibration.
- To prevent vibration we recommend you place rubber cups under each leg, at least 15mm thick under the washer, secured to at least 2 floor beams with screws.
- If possible, install the washer in one of the corners of the room, where the floor is more stable.

※ *Insert the rubber cups to reduce vibration.*

※ *You can obtain the rubber cups (p/no.4620ER4002B) from the LG spares dept.*



Important!

- Proper placement and levelling of the washer ensure long, regular and reliable operation.
- The washer must be absolutely horizontal and stand firmly in position.
- It must not “Seesaw” across corners under load.
- The installation surface must be clean, free from floor wax and other lubricant coatings.
- Do not let the legs of the washer get wet. If legs of the washer get wet, slipping may occur.

Care before washing

■ Before the first washing

Select a cycle (Cotton 60°C, add a half load of detergent) allow the unit to wash without clothing. This will remove residues and water from the drum that may have been left during manufacturing.

■ Caring before washing

1. Care Labels

Look for a care label on your clothes. This will tell you about the fabric content of your garment and how it should be washed.

2. Sorting

To get the best results, Sort clothes into loads that can be washed with the same wash cycle. Water temperature and spin speed and different fabrics need to be washed in different ways. Always sort dark colors from pale colors and whites. Wash separately as dye and lint transfer can occur causing discoloration of white etc. If possible, do not wash heavily soiled items with lightly soiled one.

- | | |
|---|---|
| Soil (Heavy, Normal, Light) | Separate clothes according to amount of soil. |
| Color (White, Lights, Dark) | Separate white fabrics from colored fabrics. |
| Lint (Lint producers, Collectors) | Wash lint producers and lint collectors separately. |

3. Caring before loading

■ **Combine large and small items in a load. Load large items first. Large items should not be more than half the total wash load.**

Do not wash single items. This may cause an out-of-balance load. Add one or two similar items.



• Check all pockets to make sure that they are empty. Items such as nails, hair clip, matches, pens, coins and keys can damage both your washer and your clothes.

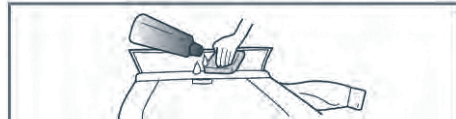

• Pre treat dirt and stains by brushing a little detergent dissolved in water onto stains like collars and cuffs to help shift dirt.

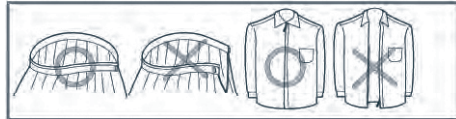

• Close zippers, hooks and strings to make sure that these items don't snag on other clothes.

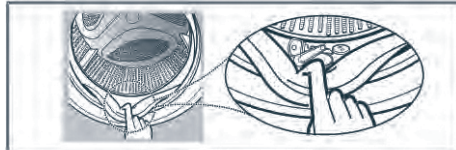

• Check the folds of the flexible gasket (gray) and remove any small articles, if any.

• Check inside of the drum and remove any left items in it for next wash cycle.



• Remove any clothing or items on the flexible gasket to prevent clothing and the gasket damages.

Adding detergent

■ Adding detergent and fabric softener

1. The Dispenser Drawer

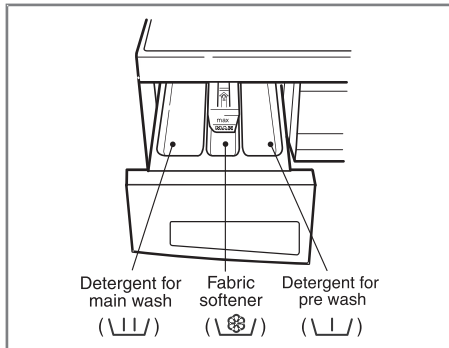

- Main wash only →
- Pre Wash + Main Wash → .

WARNING

Keep all washing detergents away from children as there is danger of poisoning. Too much detergent, bleach or softener may cause an overflow. Be sure to use the appropriate amount of detergent.

2. Adding Fabric Softener

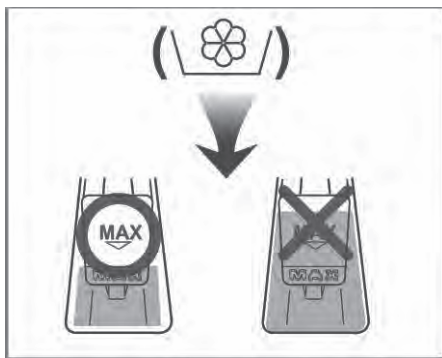

- Do not exceed the maximum fill line. Close the dispenser drawer slowly. Overfilling can cause early dispensing of the fabric softener which could stain clothes.
- Do not leave the fabric softener in the detergent drawer for more than 2 days. (Fabric softener could harden)
- Softener will be automatically added during the last rinse cycle.
- Do not open the drawer when water is supplied.
- Solvents (benzene etc) are not allowable.

NOTE Do not pour fabric softener directly on the cloths

Adding detergent

3. Detergent dosage

- The detergent should be used according to the instruction of the detergent manufacturer.
 - If too much detergent is used, too many suds can occur and this will decrease the washing result or cause heavy load to the motor.
 - It is recommended that you use powdered detergent for best results.
 - If you wish to use liquid detergent follow guidelines provided by the detergent manufacturer.
 - You can pour liquid detergent directly in to the main detergent drawer if you are starting the cycle immediately.
 - Please do not use liquid detergent if you are using 'time delay' as the liquid may harden, or if you have selected 'Pre-Wash'.
- ※ If too much suds occur, please reduce the detergent amount.
- Detergent usage may need to be adjusted for water temperature, water hardness, size and soil level of the load. For best results, avoid oversudsing.

WARNING

Do not let the detergent harden.
Doing so may lead to blockages, poor rinse performance or bad odor.

NOTE

- Full load : according to manufacturer's recommendation.
- Part load : 3/4 of the normal amount.
- Minimum load : 1/2 of full load.

- Detergent is flushed from the dispenser at the beginning of the cycle.

4. Adding water softener

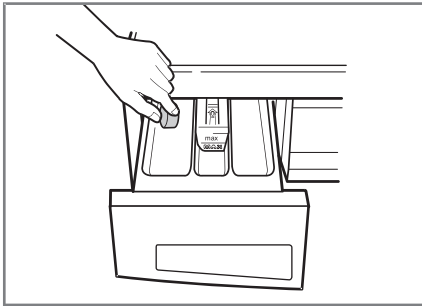

- A water softener, such as Anti limescale can be used to cut down on the use of detergent in extremely hard water areas. Dispense according to the amount specified on the packaging. First add detergent and then the water softener.
- Use the quantity of detergent as for soft water.

5. Using the Tablets

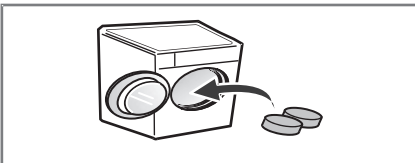

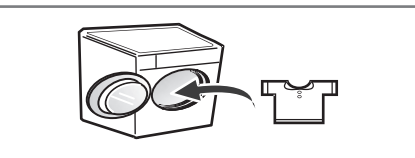

- 1) Open the door and put tablets into the drum.



- 2) Load the laundry into the drum and close the door.

■ Recommended courses according to the laundry type

Program	Description	Fabric Type	Proper Temp.	Maximum Load
Cotton	Provides better performance by combining various drum motions.	Coloured fast garments (shirts, night dresses, pajamas, etc) and normally soiled cotton load(underwear)	40°C (0°C to 95°C)	Rating
Cotton Large 	Provides optimised washing performance for large amount of laundry.		60°C (0°C to 60°C)	
Baby Care 	Washes baby clothes with gentle motion and better performance.	Lightly soiled baby wear.	60°C (60°C to 95°C)	4.0 kg
Easy Care	Suitable for casual shirts that do not need ironing after washing.	Polyamide, Acrylic, Polyester	40°C (0°C to 60°C)	3.0 kg
Mix	Enables various fabrics to be washed simultaneously.	Various kind of fabrics except special garments. (Silk/delicate, sports wear, dark clothes, wool, Duvet/Curtains).	40°C (0°C to 40°C)	
Sports Wear	Suitable for sports wear such as jogging clothes and running wear.	Coolmax, Gore-tex, fleece and Sympatex.		
Wool 	Enables to wash wool fabrics. (Please use detergent for machinewashable woolens).	Machine washable woolens with pure new wool only.	20°C (0°C to 40°C)	2.0 kg
Delicate	For delicate clothes such as underwear, blouses, etc.	Delicate, easily damaged laundry.		
Quick 30	Provides fast washing time for small loads and lightly soiled clothes.	Lightly soiled colour laundry.		
Rinse+Spin	Use for laundry that need rinsing only or to add rinse-added fabric softner to laundry.	Normal fabrics which can be washable.	-	Rating

* **Water Temperature** : Select the water temperature to the wash cycles.

Always follow garment manufacture's care label or instructions when laundering.

* **Pre Wash** : If the laundry is heavily soiled, "Pre Wash" Course is recommended.

* **Intensive** : When washing heavily soiled laundry you can increase effectiveness by choosing "Intensive" option.

* **Notes** : Neutral detergent is recommended. The "Wool" cycle features gentle tumbling and low-speed spin for garment care.

* Set Energy program at "Cotton" + "Temp. 0°C" + "Spin 1000rpm" + "Intensive" option for test in accordance or in conformity with standards IEC 60456:2010 & BEE schedule - 12 (Revision - 3).

Extra Options

Program	Intensive	Pre Wash	Time Delay
Cotton	•	•	•
Cotton Large	•	•	•
Mix	•	•	•
Easy Care	•	•	•
Baby Care	•	•**	•
Sports Wear	•		•
Delicate	•		•
Wool	•		•
Quick 30	•	•	•
Rinse+Spin			•

** : This option is automatically included in the cycle and can be deleted.

H

ow to use washer

* Part can be different according to different models.

Smart Diagnosis™ function is available only for the products with a Smart Diagnosis™ mark

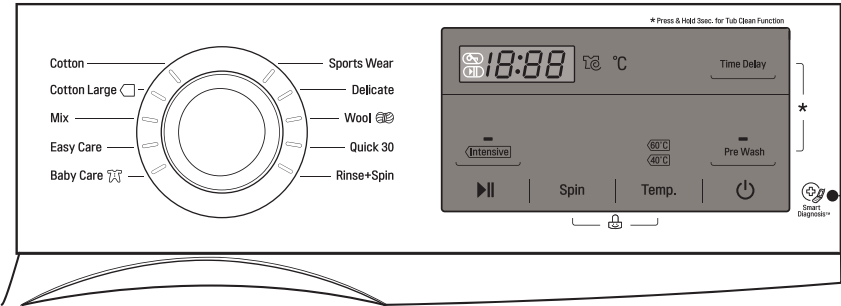

1. Cotton automatically selected upon power on.

- Press the **Power** button to start.
- Press the **Start/Pause** button.
- Initial conditions
 - **Wash** : main wash
 - **Rinse** : 3 times
 - **Spin** :
 - 1000 rpm [FHM1006#DW/L/S/
FHM1065#DW/L/S]
 - 1200 rpm [FHM1207#DW/L/S]
 - **Water temperature** : 40°C
 - **Program** : Cotton

2. Manual Selecting

- Press the **Power** button to start.
 - Press and hold Power button for 1 second to turn the washing machine off
 - Select the conditions which you want to use, by turning the program dial and pressing each button.
- For selecting specific conditions, please refer to the page15~page21*
- Press the **Start/Pause** button.

3. Beep on/off

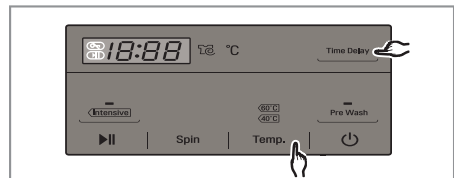

- The Beep on/off function can be set by pressing “Time delay +Temp.” button simultaneously for three seconds.
- The Beep on/off function can be set at any time, and it is cancelled by pressing “Time delay +Temp.” button simultaneously for three seconds.

H ow to use washer

*Part can be different according to different models.

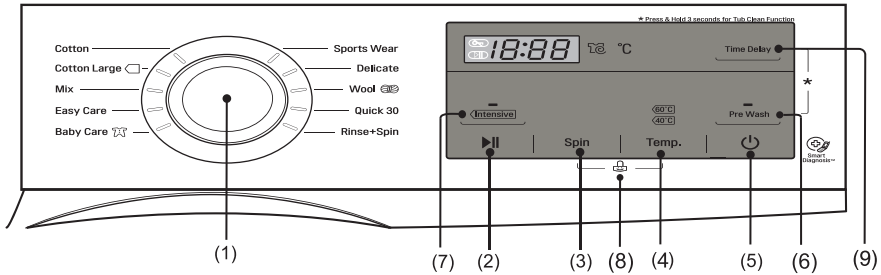

- (1) Dial : Program
- (2) Button : Start / Pause
- (3) Button : Spin
- (4) Button : Temperature
- (5) Button : Power
- (6) Button : Pre Wash
- (7) Button : Intensive
- (8) Child Lock
- (9) Button : Time Delay

Power



1. Power

- Press the Power button to turn power on and Press & hold Power button for 1 sec to turn power off.
- To cancel the Time Delay function, the power button should be pressed.

2. Initial Program

- When the Power button is pressed, the washer is ready for Cotton program and the other initial conditions as follows.
- So, if you want to advance into the washing cycle without changing the program, just press the **Start/Pause** button and then the washer will proceed.

■ Initial program

[FHM1006#DW/L/S/FHM1065#DW/L/S]

- Cotton Program / Main wash / Normal Rinse / 1000 rpm / 40°C

[FHM1207#DW/L/S]

- Cotton Program / Main wash / Normal Rinse / 1200 rpm / 40°C

Program

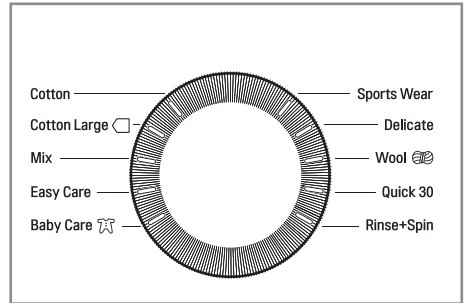

- 10 programs are available according to the laundry type.
- Lamp will light up to indicate selected program.
- When **Start/Pause** button is pressed, the Cotton program is automatically selected.
- By turning the Program dial, the program is selected in order of "Cotton – Sports Wear – Delicate – Wool – Quick 30 – Rinse+Spin – Baby Care – Easy Care – Mix – Cotton Large"

Regarding to the laundry type for each program Please refer to the page 14.

H ow to use washer

Start/Pause



1. Start

- This **Start/Pause** button is used to start wash cycle or pause the wash cycle.

2. Pause

- If temporary stop of wash cycle is needed, press the **Start/Pause** button.
- When in Pause, the power is turned off automatically after 4 minutes.
- **NB.** The door will not open before 1 to 2 minutes when Pause is selected, or at the end of the wash cycle.

Door Lock



- Door lock symbol lights whenever the door of the washer is locked.
- The door can be unlocked by pressing the Start/Pause button to stop the washer.
- The door can be opened after a short delay.

Detecting



- While the " --- " is shown in the display the machine rotates slowly and detects how much laundry is loaded in the drum. It will take a few seconds.

Option

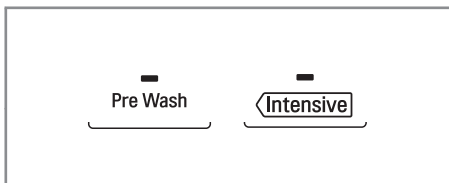

- By Pressing the Option Button, Option functions may be selected.

1. Pre Wash

- If the laundry is heavily soiled, "Pre Wash" course is recommended .

2. Intensive

- If the laundry is heavily soiled "Intensive" option is effective.
- By selecting the Intensive option, the wash time may be extended, depending on the program selected.

The required lamp will light up for identification.

H ow to use washer

Child Lock (🔒)

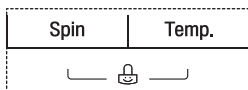

If you choose to lock the buttons on the control assembly to prevent tampering this function may be selected.

- Child Lock can be set by pressing the **Spin** button and **Temp.** button simultaneously. (About three seconds)

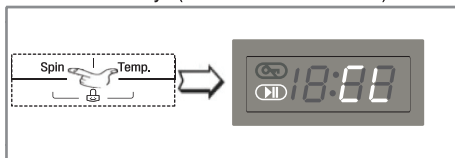

- To deactivate Child Lock system, press **Spin** and **Temp.** buttons simultaneously again. (About three seconds)

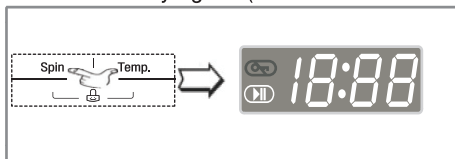

- To change to the desired program, whilst in child lock mode.

1. Press both **Spin** and **Temp.** together once again. (About three seconds)
2. Press the **Start/Pause** button.
3. Select the desired program and press the **Start/Pause** button again.

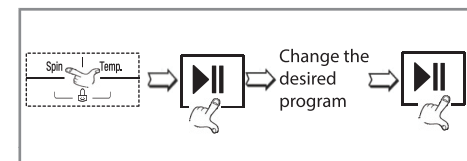

- The child lock can be set at any time and it can be deactivated only by using child lock cancel process. Turning the power off and operational errors will not affect child lock.

Tub Clean (*)

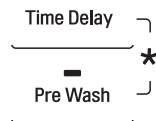

Tub Clean course can be set by pressing and holding **Time Delay** and **Pre Wash** button simultaneously.

When Tub Clean course is set, display “t c l”.



TUB CLEAN is special cycle to clean inside of the washer. This cycle uses higher water level with higher spin speed. Perform this cycle regularly.

How to use the Tub Clean cycle:

1. Remove any clothing or items from the washer and close the door.
2. Open the dispenser drawer and add Anti limescale powder to the main wash compartment.

NOTE : Do not add any detergent to the detergent compartments. Excessive suds may generate & leak from the washer.

3. Close the dispenser drawer slowly.
4. Power On and then press and hold **Time Delay** and **Pre Wash** button for 3 seconds. then “t c l” is displayed in LED.
5. Press the Start/Pause button to start.
6. After the cycle is complete, leave the door open so that moisture present inside the washer can dry.

⚠ CAUTION

If there is a small child, be careful not to leave the door open for too long.

H ow to use washer

Spin

Spin

1. Spin selection

- Spin Speed is available according to the program as follows

Program	FHM1207#D/W/L/S		FHM1006#D/W/L/S FHM1065#D/W/L/S	
	Max RPM	Default RPM	Max RPM	Default RPM
Cotton	1200	1200	1000	1000
Cotton Large	1200	1200	1000	1000
Mix	1200	1200	1000	1000
Easy Care	800	800	800	800
Baby Care	800	800	800	800
Sports Wear	800	800	800	800
Delicate	800	800	800	800
Wool	800	800	800	800
Quick 30	1200	800	1000	800
Rinse+Spin	1200	1200	1000	1000

H ow to use washer

Water Temp.

60°C
40°C

Temp.

- By pressing the Temp. button, the water temperature can be selected.
- 0°C / 20°C / 30°C / 40°C / 60°C / 95°C

- Water temperature can be selected according to the program.

Selected temperature will display on the "Multi display".

For the more detailed information, please refer to the page14.

Time Delay



Preparing washing before starting "Time Delay"

- Turn on the water tap.
- Load laundry and close the door.
- Place the detergent and fabric softener in the drawer.
- How to set "Time Delay"
 - Press **Power** button.
 - Turn the **Program** dial to select the program you require.
 - Press **Time Delay** button and set the desired time.
 - Press the **Start/Pause** button. (":" blinks.)
- If **Time Delay** button is pressed, "3:00" is displayed. The maximum delayed time is 19 hours and the minimum time is 3 hours.
- Each pressing of the button advances on time delay by one hour.
- To cancel the time delay, press the **Power** button.
- **Time Delay** is 'expected time' from the present to the completion of washing cycle or selected process (Wash, Rinse, Spin).
- **According to the condition of water supply and temperature, the delayed time and the actual washing time may vary.**

H ow to use washer

Display



1. Special function display

- When child lock is selected, the “**CL**” is displayed.
- When time delay is selected, it shows the remaining time to finish the selected program.

2. Self diagnosis display

- If the machine encounters a fault during operation, the associated fault will be displayed.
 - “**PE**” : Water pressure sensing error
 - “**FE**” : Problem of overfilling water
 - “**dE**” : Door is not closed
 - “**FF**” : Supply/Drain hose or drain pump frozen
 - “**LE**” : Over load in motor
 - “**IE**” : Water inlet trouble
 - “**DE**” : Drainage trouble
 - “**UE**” : Unbalanced load
 - “**EE**” : Control error

If these error letters are displayed, please refer to the troubleshooting page 28 and follow the guide.

3. Completion of washing

- When washing cycle is completed, “**End**” is displayed on the “*Multi display*”.

4. Time left

- During washing cycle, the remaining washing time is displayed.
- The washing time may vary by the amount of laundry, water pressure, water temperature and other washing conditions.
- If an unbalanced load is detected or if the suds removing program operates, the wash time may be extended.

Maintenance

- * Before cleaning the washer interior, unplug the electrical power cord to avoid electrical shock to avoid electrical shock hazards.
- * When disposing of the appliance, cut off the mains cable, and destroy the plug. Disable the door lock to prevent young children being trapped inside.

■ The water inlet filter

- " **IE** " error message will blink on the control panel when water does not enter the detergent drawer.
- If water is very hard or contains traces of lime deposit, the water inlet filter may become clogged.
It is therefore a good idea to clean it from time to time.

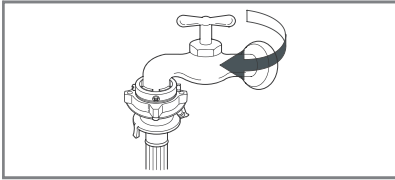

1. Turn off the water tap.

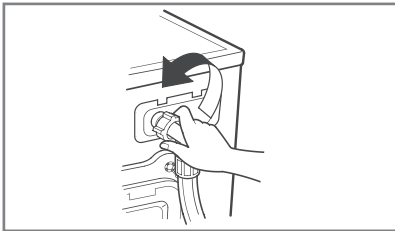

2. Unscrew the water inlet hose.

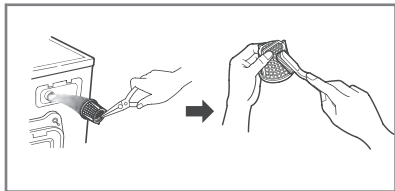

3. Clean the filter using a hard bristle brush.

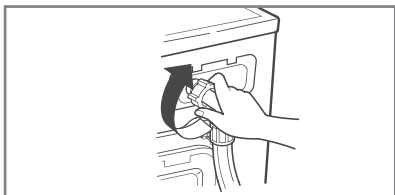

4. Tighten up the inlet hose.

Maintenance

■ The drain pump filter

* The drain filter collects threads and small objects left in the laundry.

Check regularly that the filter is clean to ensure smooth running of your machine.

⚠ CAUTION First drain using the drain hose and then open the pump filter to remove whatever any threads or objects.

Be careful when draining if the water is hot.

* Allow the water to cool down before cleaning the drain pump, carrying out emergency emptying or opening the door in an emergency.

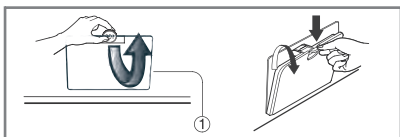

1. Open the lower cover cap (1) by using a coin.

Drain plug (2) to pull out the hose.

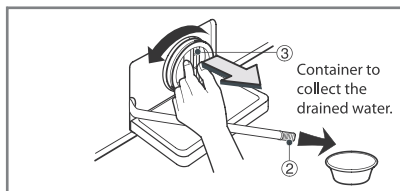

2. Unplug the drain plug (2), allowing the water to flow out. At this time use a vessel to prevent water flowing on to the floor. When water does not flow any more, turn the pump filter (3) open to the left.

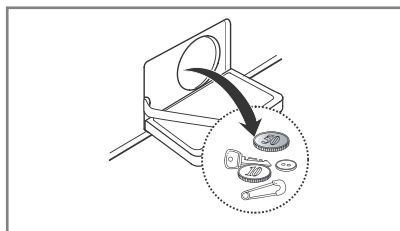

3. Remove out any foreign material from the pump filter (3).

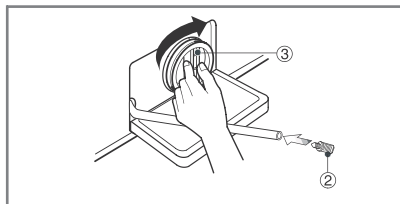

4. After cleaning, turn the pump filter (3) clockwise and insert the drain plug (2) to the original place. Close the lower cover cap.

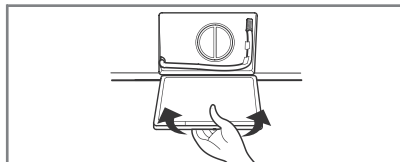

■ Dispenser drawer

- * After a while detergents and fabric softeners leave a deposit in the drawer.
- It should be cleaned from time to time with a jet of running water.
- If necessary it can be removed completely from the machine by pressing the latch downwards and by pulling it out.
- To facilitate cleaning, the upper part of the fabric softener compartment can be removed.

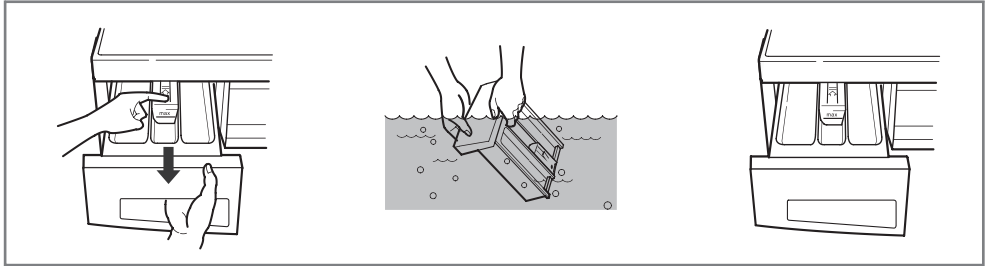

■ The drawer recess

- * Detergent can also accumulate inside the recess which should be cleaned occasionally with an old toothbrush.
- Once you have finished cleaning, replace the drawer and run a rinse cycle without laundry.

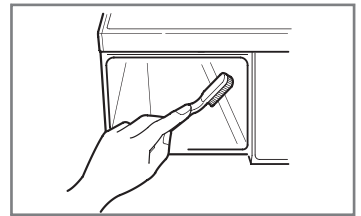

■ The washing drum

- If you live in a hard water area, limescale may continuously build up in places where it cannot be seen and thus not easily removed.
Over time the build up of scale clogs appliances, and if it is not kept in check these may have to be replaced.
- Although the washing drum is made of Stainless steel, specks of rust can be caused by small metal articles (paper clips, safety pins) which have been left in the drum.
- The washing drum should be cleaned from time to time.
- If you use descaling agents, dyes or bleaches, make sure they are suitable for washing machine use.
- * Descaler may contain chemicals that may damage part of your washing machine.
- * Remove any spots with a stainless steel cleaning agent.
- * Never use steel wool.

■ Cleaning your washer

1. Exterior

Proper care of your washer can extend its life.

The outside of the machine can be cleaned with warm water and a neutral non abrasive household detergent.

Immediately wipe off any spills. Wipe with damp cloth.

Try not to hit surface with sharp objects.

* IMPORTANT: Do not use methylated spirits, diluents or similar products.

2. Interior

Dry around the washer door opening, flexible gasket and door glass.

Run washer through a complete cycle using hot water.

Repeat process if necessary.

NOTE Remove hard water deposits using only cleaners labeled as washer safe.

■ Cold condition

If the washer is stored in an area where freezing may occur or moved in freezing temperatures, the washer may not operate normally,

Follow the below said instruction to prevent damage to the washer

1. Turn off water supply tap.
2. Disconnect hoses from water supply and drain water from hoses.
3. Plug electrical cord into a properly grounded electrical outlet.
4. Add 1gallon(3.8L) of nontoxic recreational vehicle(RV) antifreeze into an empty wash drum.
Close the door.
5. Set spin cycle and let washer spin for 1minute to drain out all water.
Not all of the RV antifreeze will be expelled.
6. Unplug electrical power cord, dry the drum interior, and close the door.
7. Remove dispenser drawer drain and dry excessive water from the compartments.
8. Store washer in an upright position.
9. To remove antifreeze from washer after storage, run empty washer through a complete cycle using detergent. Do not add wash load.

Troubleshooting guide

* This washing machine is equipped with automatic safety functions which detect and diagnose faults at an early stage and react appropriately
 When the machine does not function properly or does not function at all, check the following points before you contact your service provider.











Symptom	Possible Cause	Solution
Rattling and clanking noise	<ul style="list-style-type: none"> Foreign objects such as coins or safety pins maybe in drum or pump. 	<p>Stop washer and check drum and drain filter.</p> <p>If noise continues after washer is restarted, call your authorised service centre.</p>
Thumping sound	<ul style="list-style-type: none"> Heavy wash loads may produce a thumping sound. This is usually normal. 	<p>If sound continues, washer is probably out of balance. Stop and redistribute wash load.</p>
Vibrating noise	<ul style="list-style-type: none"> Have all the transit bolts and packing been removed? Are all the feet resting firmly on the ground? 	<p>If not removed during installation. Refer to Installation guide for removing transit bolts.</p> <p>Wash load may be unevenly distributed in drum. Stop washer and rearrange wash load.</p>
Water leaks	<ul style="list-style-type: none"> Fill hoses or drain hose are loose at tap or washer. House drain pipes are clogged. 	<p>Check and tighten hose connections.</p> <p>Unclog drain pipe. Contact plumber if necessary.</p>
Oversudsing		<p>Too much detergent or unsuitable detergent may cause excessive foaming which may result in water leaks.</p>
Water does not enter washer or it enters slowly	<ul style="list-style-type: none"> Water supply is not adequate in area. Water supply tap is not completely open. Water inlet hose(s) are kinked. The filter of the inlet hose(s) clogged. 	<p>Check another tap in the house.</p> <p>Fully open tap.</p> <p>Straighten hose.</p> <p>Check the filter of the inlet hose.</p>
Water in the washer does not drain or drains slowly	<ul style="list-style-type: none"> Drain hose is kinked or clogged. The drain filter is clogged. 	<p>Clean and straighten the drain hose.</p> <p>Clean the drain filter</p>

T

roubleshooting guide

Symptom	Possible Cause	Solution
Washer does not start	<ul style="list-style-type: none"> • Electrical power cord may not be plugged in or connection may be loose. • House fuse blown, circuit breaker tripped, or a power outage has occurred. • Water supply tap is not turned on. 	<p>Make sure plug fits tightly in wall outlet.</p> <p>Reset circuit breaker or replace fuse. Do not increase fuse capacity. If problem is a circuit overload, have it corrected by a qualified electrician. Turn on water supply tap.</p>
Washer will not spin	<ul style="list-style-type: none"> • Check that the door is firmly shut. 	<p>Close the door and press the Start/Pause button. After pressing the Start/Pause button, it may take a few moments before the clothes washer begins to spin. The door must lock before spin can be achieved.</p> <p>Add 1 or 2 similar items to help balance the load. Rearrange load to allow proper spinning.</p>
Door does not open		<p>Once machine has started, the door can not be opened for safety reasons. Check if the "Door Lock" icon is illuminated. You can safely open the door after the "Door Lock" icon turns off.</p>
Wash cycle time delayed		<p>The washing time may vary by the amount of laundry, water pressure, water temperature and other usage conditions.</p> <p>If the imbalance is detected or if the suds removing program works, the wash time shall be increased.</p>
Fabric softner overflow	<ul style="list-style-type: none"> • Too much softener may cause an overflow. 	<p>Follow softener guidelines to ensure appropriate amount is used. Do not exceed the maximum fill line.</p>
Softeners dispensed too early		<p>Close the dispenser drawer slowly. Do not open the drawer during the wash cycle.</p>

Troubleshooting guide

Symptom	Possible Cause	Solution
	<ul style="list-style-type: none"> • Water supply is not adequate in area. • Water supply taps are not completely open. • Water inlet hose(s) are kinked. • The filter of the inlet hose(s) are clogged. 	<p>Check another tap in the house. Fully open tap. Straighten hose(s). Check the filter of the inlet hose.</p>
	<ul style="list-style-type: none"> • Drain hose is kinked or clogged. • The drain filter is clogged. 	<p>Clean and straighten the drain hose. Clean the drain filter.</p>
	<ul style="list-style-type: none"> • Load is too small. • Load is out of balance. • The appliance has an imbalance detection and correction system. If individual heavy articles are loaded (ex. bath mat, bath robe, etc.) this system may stop spinning or even interrupt the spin cycle altogether. • If the laundry is still too wet at the end of the cycle, add smaller articles of laundry to balance the load and repeat the spin cycle. 	<p>Add 1 or 2 similar items to help balance the load. Rearrange load to allow proper spinning</p>
	<ul style="list-style-type: none"> • Is the door opened? 	<p>Close the door and press Start/Pause button two times. *Still, if “dE” is not released, call for service.</p>
	<ul style="list-style-type: none"> • Control error. 	<p>Unplug the power plug and call for service.</p>
	<ul style="list-style-type: none"> • Water overfills due to the faulty water valve. 	<p>Close the water tap. Unplug the power plug. Call for service.</p>
	<ul style="list-style-type: none"> • Water level sensor has malfunctioned. 	
	<ul style="list-style-type: none"> • Over load in motor. 	<p>Allow the washing machine to stand for 30 minutes to allow the motor to cool, then restart the cycle. If still error comes stop the machine and call for service.</p>
	<ul style="list-style-type: none"> • Is supply/drain hose or drain pump frozen? 	<p>Supply warm water into the drum and unfreeze drain hose and drain pump. Wet a towel in warm water and apply to supply hose.</p>

Troubleshooting guide

Smart Diagnosis™ Using a Smart Phone

- For appliances with the  or  logo

Use this function if you need an accurate diagnosis by an LG Electronics customer information centre when the appliance malfunctions or fails.

Smart Diagnosis™ can not be activated unless the appliance is connected to power. If the appliance is unable to turn on, then troubleshooting must be done without using Smart Diagnosis™.

Using Smart Diagnosis™

Smart Diagnosis™ Through the Customer Information Centre

Use this function if you need an accurate diagnosis by an LG Electronics customer information centre when the appliance malfunctions or fails. Use this function only to contact the service representative, not during normal operation.

- 1 Press the **Power** button to turn on the washing machine. Do not press any other buttons or turn the programme selector knob.
- 2 When instructed to do so by the call centre, place the mouthpiece of your phone close to the **Power** button.

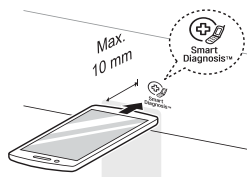

- 3 Press and hold the **Temp.** button for three seconds, while holding the phone mouthpiece to the icon or **Power** button.

- 4 Keep the phone in place until the tone transmission has finished. Time remaining for data transfer is displayed.

- For best results, do not move the phone while the tones are being transmitted.
- If the call centre agent is not able to get an accurate recording of the data, you may be asked to try again.

- 5 Once the countdown is over and the tones have stopped, resume your conversation with the call centre agent, who will then be able to assist you using the information transmitted for analysis.

NOTE

- The Smart Diagnosis™ function depends on the local call quality.
- The communication performance will improve and you can receive better service if you use the home phone.
- If the Smart Diagnosis™ data transfer is poor due to poor call quality, you may not receive the best Smart Diagnosis™ service.

Terms of Warranty

What Is Not Covered:

- Service trips to your home to teach you how to use the product.
- If the product is connected to any voltage other than that shown on the rating plate.
- If the fault is caused by accident, neglect, misuse or Act of God.
- If the fault is caused by factors other than normal domestic use or use in accordance with the owner's manual.
- Provide instruction on use of product or change the set-up of the product.
- If the fault is caused by pests for example, rats or cockroaches etc..
- Noise or vibration that is considered normal for example water drain sound, spin sound, or warming beeps.
- Correcting the installation for example, levelling the product, adjustment of drain.
- Normal maintenance which recommended by the owner's manual.
- Removal of foreign objects / substances from the machine, including the pump and inlet hose filter for example, grit, nails, bra wires, buttons etc.
- Replace fuses in or correct house wiring or correct house plumbing.
- Correction of unauthorized repairs.
- Incidental or consequential damage to personal property caused by possible defects with this appliance.
- If this product is used for commercial purpose, it is not warranted.

(Example : Public places such as public bathroom, lodging house, training center, dormitory)

If the product is installed outside the normal service area, any cost of transportation involved in the repair of the product, or the replacement of a defective part, shall be borne by the owner.

Disposal of your old appliance (as per e-waste Rules)



1. When this crossed out wheeled bin symbol is depicted on the product and its operator's manual, it means the product is covered by the e-waste Management and Handling Rules , 2011 and are meant to be recycled, dismantled, refurbished or disposed off.

2. Dos

- a. The product is required to be handed over only to the authorized recycler for disposal.
- b. Keep the product in isolated area, after it becomes non-functional/un-repairable so as to prevent its accidental breakage.

Don't

- a. The product should not be opened by the user himself/herself, but only by authorized service personnel.
- b. The product is not meant for re-sale to any unauthorized agencies/scrap dealer/ kabariwalah.
 - c. The product is not meant for mixing into household waste stream.
 - d. Do not keep any replaced spare part(s) from the product in exposed area.
 - e. Any disposal through unauthorized agencies/person will attract action under Environment (Protection) Act 1986.
 - f. This product does not contain any of the hazardous substances as specified in rule 13(1) and (2) of the e-waste (Management and Handling) Rules, 2011.
 - g. To locate a nearest collection centre or call for pick-up (limited area only) for disposal of this appliance, please contact Toll Free No. **1800-315-9999 / 1800-180-9999** for details. All collection centre and pick up facilities are done by third parties with **LG Electronics India Pvt. Ltd.** merely as a facilitator.

For more detailed information , please visit : <http://www.lg.com/in> ☎ **9711709999** (LG WhatsApp No.)

अपने पुराने उपकरण का निपटान (ई-अपशिष्ट नियम के अनुसार)



१. जब इस संकेत वाले पहिये वाले बिन का चिह्न किसी उपकरण और इसके ओपरेटर की पुस्तिका के साथ संलग्न होता है तो इसका मतलब है कि इसे "ई-अपशिष्ट" (प्रबंधन और हथालन) नियम २०११ के अन्तर्गत सम्मिलित किया गया है। और इसे नवीनीकरण, विघटन और निपटाना के लिए बनाया गया है।

२. करें-

- क- उपकरण को सिर्फ अधिकृत पुनः नवीनीकरणकर्ता को ही निपटारण करने हेतु हस्तांतरित करें।
- ख- जब उपकरण कार्यरत न हो इसे अलग क्षेत्र में रखें ताकि उपकरण से होने वाली दुर्घटनाओं से बचा जा सके।

ना करें-

क- इस उपकरण को स्वयं/खुद नही खोलना चाहिए, उपकरण को केवल अधिकृत अधिकारी के द्वारा ही खोला जाना चाहिए।

ख- इस उपकरण को पुनः बिक्री के लिए किसी भी कबाड़ीवाला / मंगार वाला / अनाधिकृत संस्था को न दें।

ग- इस उपकरण को किसी घरेलू अपशिष्ट सामान के साथ मिलाकर न रखें।

घ- उपकरण के बदले हुए या आंतरिक पुर्जों को खुले क्षेत्र में न रखें।

३. यदि किसी अनाधिकृत विभाग या व्यक्ति के द्वारा निपटारण किया जाता है तो यह पर्यावरण (सुरक्षा) धारा १९८६ के अन्तर्गत आता है।

४. यह उत्पाद ई-अपशिष्ट (प्रबंधन और हथालन) नियम २०११ के अन्तर्गत 13(1) एवं (2) के तहत निर्दिष्ट खतरनाक पदार्थों की आवश्यकता का पालन करता है।

५. उपरोक्त पदार्थों के निपटारण के लिए नजदीकी निपटारण संस्थान (संकीर्ण क्षेत्र) में कॉल करें। अधिक जानकारी के लिए हमारे टोल फ्री नम्बर **१८००.३१५.९९९९ / १८००.१८०.९९९९** पर कॉल करें। सभी संग्रहण केन्द्र व पिक-अप की सुविधाएं किसी थर्ड-पार्टी जो **"LG Electronics India Pvt. Ltd"** को अपनी सेवाएं प्रदान कर रही हों, से करवाएं।

अधिक जानकारी के लिए देखें वेबसाइट : <http://www.lg.com/in> ☎ **9711709999** (LG WhatsApp No.)



MFL71716206

LG 24 x 7 CUSTOMER CARE

1800-315-9999
1800-180-9999
(Toll Free)

5757554
(Send SMS)

www.lg.com/in/support

LG WhatsApp No.
9711709999

LG Service India Mobile App
Available at Google Play

www.facebook.com/lgindiapage/

www.twitter.com/LGIndia

To know more about LG,
visit www.lg.com/in
For Corporate/Institutional enquiries,
please write to corp.enquiries@lge.com